

MJC 挠性联轴器 - 梅花型 - 定位螺丝固定型 型号变更 规格变更

高扭矩 减振 电绝缘性

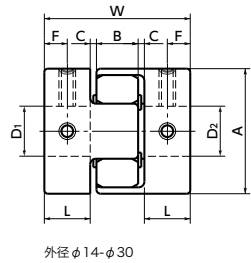

外径 φ14-φ30

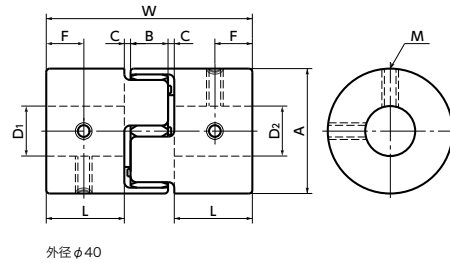
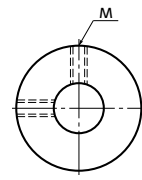

外径 φ40

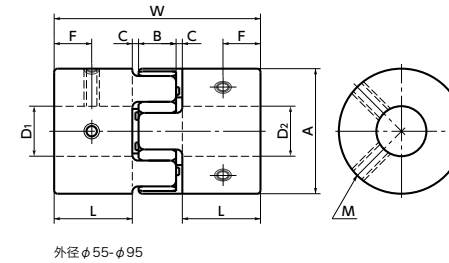

外径 φ55-φ95

● 弹性间隔体详图

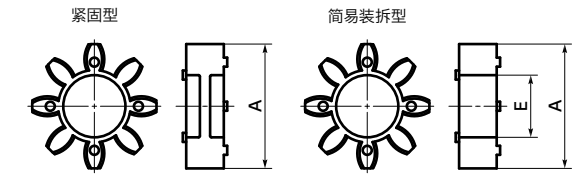

● 环境温度、温度修正系数

环境温度	温度修正系数
-20°C~30°C	1.00
30°C~40°C	0.80
40°C~60°C	0.70

尺寸

单位: mm

型号	A	L	W	B	C*1	弹性间隔体 E	F	M	螺丝紧固扭矩 (N·m)
MJC-14	14	7	22	6	1	4	3.5	M3	0.7
MJC-20	20	10	30	8	1	6	5	M3	0.7
MJC-25	25	12	34	8	1	8	6	M4	1.7
MJC-30	30	11	35	10	1.5	10	5.5	M4	1.7
MJC-40	40	25	66	12	2	17	12.5	M5	4
MJC-55	55	30	78	14	2	26	15	M6	7
MJC-65	65	35	90	15	2.5	29.5	17.5	M8	15
MJC-80	80	45	114	18	3	35.5	22.5	M8	15
MJC-95	95	50	126	20	3	44	25	M8	15

*1: 在使用时请一定留出C尺寸。

型号	标准轴孔径(尺寸容许偏差H8)																																
	3	4	4.5	5	6	6.35	7	8	9.525	10	11	12	14	15	16	18	19	20	22	24	25	28	30	32	35	38	40	42	45	48	50	55	
MJC-14	●	●	●	●	●	●	●																										
MJC-20		●	●	●	●	●	●	●	●	●	●																						
MJC-25			●	●	●	●	●	●	●	●	●	●	●																				
MJC-30				●	●	●	●	●	●	●	●	●	●	●	●																		
MJC-40					●	●	●	●	●	●	●	●	●	●	●	●	●	●	●	●	●	●	●	●	●	●	●	●	●	●	●	●	
MJC-55						●	●	●	●	●	●	●	●	●	●	●	●	●	●	●	●	●	●	●	●	●	●	●	●	●	●	●	
MJC-65							●	●	●	●	●	●	●	●	●	●	●	●	●	●	●	●	●	●	●	●	●	●	●	●	●	●	●
MJC-80								●	●	●	●	●	●	●	●	●	●	●	●	●	●	●	●	●	●	●	●	●	●	●	●	●	●
MJC-95									●	●	●	●	●	●	●	●	●	●	●	●	●	●	●	●	●	●	●	●	●	●	●	●	●

型号	标准轴孔径(尺寸容许偏差H7)																																	
	1/8	3/16	1/4	5/16	3/8	7/16	1/2	9/16	5/8	11/16	3/4	13/16	7/8	15/16	1	1-1/8	1-1/4	1-3/8	1-1/2	1-5/8	1-3/4													
MJC-14	●	●	●																															
MJC-20		●	●	●	●																													
MJC-25			●	●	●	●	●																											
MJC-30				●	●	●	●	●	●																									
MJC-40					●	●	●	●	●	●	●	●	●	●																				
MJC-55						●	●	●	●	●	●	●	●	●	●	●	●	●	●	●	●	●	●	●	●	●	●	●	●	●	●	●	●	
MJC-65							●	●	●	●	●	●	●	●	●	●	●	●	●	●	●	●	●	●	●	●	●	●	●	●	●	●	●	●
MJC-80								●	●	●	●	●	●	●	●	●	●	●	●	●	●	●	●	●	●	●	●	●	●	●	●	●	●	●
MJC-95									●	●	●	●	●	●	●	●	●	●	●	●	●	●	●	●	●	●	●	●	●	●	●	●	●	●

- 所有产品均附带内六角止动螺丝。
- 轴孔径为 φ4 以下时, 附带 1 个止动螺丝。
- 适用轴径的推荐尺寸公差为 h6 及 h7。
- 也承接 1 个轴套是定位螺丝固定型, 另 1 个轴套是夹紧型等组合的订货。
- 轴插入联轴器中的量请参阅安装与维护说明。→ P.xxxx

轴孔·键槽追加加工 → P.xxxx 无尘洗净·无尘包装 → P.xxxx 变更为不锈钢螺丝 → P.xxxx

性能

型号	弹性间隔体		最大轴孔径 (mm)	额定*1 扭矩 (N·m)	最大*1 扭矩 (N·m)	零背隙*3 容许传递扭矩 (N·m)	最高转速 (min ⁻¹)	惯性*2 力矩 (kg·m ²)	静态扭转刚性 (N·m/rad)	容许偏心 (mm)	容许偏角 (°)	容许轴向偏差 (mm)	质量*2 (g)	弹性间隔体硬度 (JIS)
	紧固型	简易拆装型												
MJC-14	BL	EBL	7	0.7	1.4	0.1	45000	2.0 x 10 ⁻⁷	8	0.15	1	+0.6 0	6.6	A80
MJC-20	BL	EBL	11	1.8	3.6	0.2	31000	1.1 x 10 ⁻⁶	16	0.2	1	+0.8 0	17	A80
MJC-25	BL	EBL	12.7	3	6	0.4	25000	3.3 x 10 ⁻⁶	32	0.2	1	+0.9 0	34	A80
MJC-30	BL	EBL	16	4	8	0.5	21000	6.2 x 10 ⁻⁶	46	0.2	1	+1.0 0	44	A80
MJC-40	BL	EBL	25	4.9	9.8	1.2	15000	3.7 x 10 ⁻⁵	380	0.15	1	+1.2 0	130	A80
MJC-55	BL	EBL	32	17	34		11000	1.6 x 10 ⁻⁴	1400	0.2	1	+1.4 0	320	A80
MJC-65	BL	EBL	38.1	46	92		9000	3.6 x 10 ⁻⁴	2800	0.2	1	+1.5 0	520	A80
MJC-80	BL	EBL	45	95	190		7000	1.1 x 10 ⁻³	3200	0.2	1	+1.8 0	1000	A80
MJC-95	BL	EBL	55	130	260		6000	2.3 x 10 ⁻³	3600	0.2	1	+2.0 0	1500	A80
MJC-14	WH	EWH	7	1.2	2.4	0.1	45000	2.0 x 10 ⁻⁷	14	0.1	1	+0.6 0	6.6	A92
MJC-20	WH	EWH	11	3	6	0.2	31000	1.1 x 10 ⁻⁶	29	0.15	1	+0.8 0	17	A92
MJC-25	WH	EWH	12.7	5	10	0.4	25000	3.3 x 10 ⁻⁶	60	0.15	1	+0.9 0	34	A92
MJC-30	WH	EWH	16	7.5	15	0.5	21000	6.2 x 10 ⁻⁶	73	0.15	1	+1.0 0	44	A92
MJC-40	WH	EWH	25	10	20	1.2	15000	3.7 x 10 ⁻⁵	570	0.1	1	+1.2 0	130	A92
MJC-55	WH	EWH	32	35	70		11000	1.6 x 10 ⁻⁴	1600	0.15	1	+1.4 0	320	A92
MJC-65	WH	EWH	38.1	95	190		9000	3.6 x 10 ⁻⁴	3000	0.15	1	+1.5 0	520	A92
MJC-80	WH	EWH	45	190	380		7000	1.1 x 10 ⁻³	5300	0.15	1	+1.8 0	1000	A92
MJC-95	WH	EWH	55	265	530		6000	2.3 x 10 ⁻³	6200	0.15	1	+2.0 0	1500	A92
MJC-14	RD	ERD	7	2	4	0.1	45000	2.0 x 10 ⁻⁷	22	0.1	1	+0.6 0	6.6	A98
MJC-20	RD	ERD	11	5	10	0.2	31000	1.1 x 10 ⁻⁶	55	0.1	1	+0.8 0	17	A98
MJC-25	RD	ERD	12.7	7.2	14.4	0.4	25000	3.3 x 10 ⁻⁶	120	0.1	1	+0.9 0	34	A98
MJC-30	RD	ERD	16	12.5	25	0.5	21000	6.2 x 10 ⁻⁶	130	0.1	1	+1.0 0	44	A98
MJC-40	RD	ERD	25	17	34	1.2	15000	3.7 x 10 ⁻⁵	1200	0.1	1	+1.2 0	130	A98
MJC-55	RD	ERD	32	60	120		11000	1.6 x 10 ⁻⁴	2600	0.1	1	+1.4 0	320	A98
MJC-65	RD	ERD	38.1	160	320		9000	3.6 x 10 ⁻⁴	4900	0.1	1	+1.5 0	520	A98
MJC-80	RD	ERD	45	325	650		7000	1.1 x 10 ⁻³	6500	0.1	1	+1.8 0	1000	A98
MJC-95	RD	ERD	55	450	900		6000	2.3 x 10 ⁻³	8900	0.1	1	+2.0 0	1500	A98
MJC-14	GR	EGR	7	2.4	4.8	0.1	45000	2.0 x 10 ⁻⁷	66	0.08	1	+0.6 0	6.6	D64
MJC-20	GR	EGR	11	6	12	0.2	31000	1.1 x 10 ⁻⁶	87	0.08	1	+0.8 0	17	D64
MJC-25	GR	EGR	12.7	9.6	19.2	0.4	25000	3.3 x 10 ⁻⁶	160	0.08	1	+0.9 0	34	D64
MJC-30	GR	EGR	16	16	32	0.5	21000	6.2 x 10 ⁻⁶	200	0.08	1	+1.0 0	44	D64
MJC-40	GR	EGR	25	21	42	1.2	15000	3.7 x 10 ⁻⁵	3000	0.08	1	+1.2 0	130	D64
MJC-55	GR	EGR	32	75	150		11000	1.6 x 10 ⁻⁴	9000	0.08	1	+1.4 0	320	D64
MJC-65	GR	EGR	38.1	200	400		9000	3.6 x 10 ⁻⁴	13000	0.08	1	+1.5 0	520	D64
MJC-80	GR	EGR	45	405	810		7000	1.1 x 10 ⁻³	14000	0.08	1	+1.8 0	1000	D64
MJC-95	GR	EGR	55	560	1120		6000	2.3 x 10 ⁻³	15000	0.08	1	+2.0 0	1500	D64

*1: 无需根据负荷变化修正额定扭矩和最大扭矩。但环境温度高于 30°C 时, 请依据表中的温度修正系数调整额定扭矩及最大扭矩。MJC 的可使用温度为 -20°C ~ 60°C。详情请参考选型步骤。

*2: 最大轴孔径时的值。

*3: 传递零背隙扭矩时, 请使用紧固型弹性间隔体。

● 型号指定

MJC-95-EBL-40-45

