

D07 – 60G/60GM 型

质量流量控制器/流量计

使用手册



北京七星华创电子股份有限公司
BEIJING SEVENSTAR ELECTRONICS CO., LTD.

2015 . 12

目 录

1. 用途和特点	1	6. 注意事项	16
2. 主要技术指标	2	6.1 禁用流量介质	16
3. 结构和工作原理	3	6.2 使用腐蚀性气体问题	16
3.1 结构.....	3	6.3 阀口密封问题	16
3.2 工作原理.....	3	6.4 阀控操作注意	17
4. 安装和接线	4	6.5 安装位置问题	17
4.1 外形及安装尺寸.....	4	6.6 注意工作压差	17
4.2 气路接头形式.....	9	6.7 标定和不同气体的换算	17
4.3 连接电缆插头.....	10	6.8 D07-60G、60GM 标准订单填写格式	18
4.4 与计算机信号的连接.....	11	7. 故障判断和处理	21
4.5 调零和外调零.....	13	8. 保证、保修与服务	23
5. 使用方法和操作步骤	14	8.1 产品保证和保修.....	23
5.1 质量流量控制器的操作.....	14	8.2 保修对使用的要求.....	23
5.1.1 开机操作.....	14	8.3 服务.....	23
5.1.2 清洗功能.....	15	9. 附录	25
5.1.3 显示器与计算机连接的操作.....	15	9.1 气体质量流量转换系数	25
5.1.4 直接与计算机连接的操作.....	15	9.2 转换系数使用说明	27
5.1.5 阀控功能.....	15		
5.1.6 关机操作.....	15		

MASS FLOW CONTROLLER & MASS FLOW METER

质量流量控制器和质量流量计

使用手册

1. 用途和特点

质量流量计(Mass Flow Meter 缩写为 MFM) 用于对气体的质量流量进行精密测量；质量流量控制器 (Mass Flow Controller 缩写为 MFC) 用于对气体的质量流量进行精密测量和控制。它们在半导体微电子工业、特种材料研制、化学工业、石油工业、医药、环保和真空等多种领域的科研和生产中有着重要的应用。其典型的应用场合包括: 电子工艺设备, 如扩散、氧化、外延、CVD、等离子刻蚀、溅射、离子注入; 以及真空镀膜设备、光纤熔炼、微反应装置、混气配气系统、毛细管测量、气相色谱仪及其它分析仪器。

D07 系列质量流量控制器和质量流量计具有精度高、重复性好、响应速度快、软启动、稳定可靠、工作压力范围宽等特点(可以在高压或真空条件下工作), 其操作使用方便, 可任意位置安装, 并便于与计算机连接实现自动控制。

D07-60G 型质量流量控制器和质量流量计均为 24V 单电源供电, 一般与我公司 D08-1K 型流量显示仪配套使用, 控制控制器与显示之间用专用电缆连接(如图 1 所示)。



图 1. 质量流量计与流量显示仪配套使用

2. 主要技术指标: 表 1. D07-60G 型 MFC 性能指标

编号	项 目	D07-60G	D07-60GM
1	流量规格	300, 500, 750, 1000, 1500, 2000SLM	
2	准确度	± 2% F.S.	
3	线性	±1% F.S.	
4	重复精度	±0.2%F.S.	
5	响应时间	< 10 sec	
6	工作压差范围	(0.25 ~ 0.5) MPa (≤1000SLM) (0.4 ~ 0.6) MPa (>1000SLM)	<0.2 MPa
7	耐压	3 MPa	
8	工作环境温度	5~ 45 °C	
9	输入信号	4~20 mA 或 1~5 VDC	无
10	输出信号	4~20 mA 或 1~5 VDC	
11	阀的类型	常闭	无
12	电源	+24VDC 400 mA	
13	外形尺寸	见图 3a、3b、3c、3d	
14	重量	6 kg	5 kg

注意▲:

质量流量计和质量流量控制器出厂通常用氮气 (N₂) 标定。

质量流量的单位规定为: SCCM (标准毫升/分);

SLM (标准升/分)

标准状态规定为: 温度 -- 273.15K (0°C);

气压 — 101325 Pa (760mm Hg)

在七星电子 MFC/MFM 产品中, 单位 SCCM 和 “mL/min, 0°C,1atm” 等同, 单位 SLM 和 “L/min, 0°C,1atm” 等同。

F.S. (Full Scale): 满量程值

3. 结构和工作原理

3.1 结构

D07-60G 质量流量控制器由流量传感器，分流器通道、流量控制阀及进出气接头和控制电路板等部件组成。D07-60GM 与 D07-60G 相比无流量控制阀。

3.2 工作原理

流量传感器采用毛细管传热温差量热法原理测量气体的质量流量(无需温度压力补偿)。将传感器加热电桥测得的流量信号送入放大器放大，放大后的流量检测电压与设定电压进行比较，再将差值信号放大后去控制调节阀门，闭环控制流过通道的流量使之与设定的流量相等。分流器决定主通道的流量。与之配套的 D08 流量显示仪上设置有稳压电源, 3 位半数字电压表, 设定电位器, 外设、内设转换和三位阀控开关等。D07-60G 质量流量控制器与流量显示仪连接后的工作原理如图 2 所示。



图 2. 质量流量控制器原理

控制器输出的流量检测信号与流过通道的质量流量成正比，流量检测输出电流为4~20mA(或 1~5VDC)。质量流量控制器的流量控制范围是(2~100)%F.S.，当设定值<2%F.S.时，阀门将处于关闭状态。质量流量控制器和质量流量计的流量分辨率是 0.1%F.S.。

注意▲:

当质量流量控制器的“阀控”线置于“清洗”位时，也可以当质量流量计使用。在做流量计使用时，流量检测电压的输出值最大可能达+10V 以上，不过要注意，当流量超过满量程值(+5V) 后，流量检测电压与通过的实际流量不成线性对应关系。清洗时，流量显示不准确，还可能出现流量增大显示反而减小的异常现象，但并不会对流量计本身造成损伤。

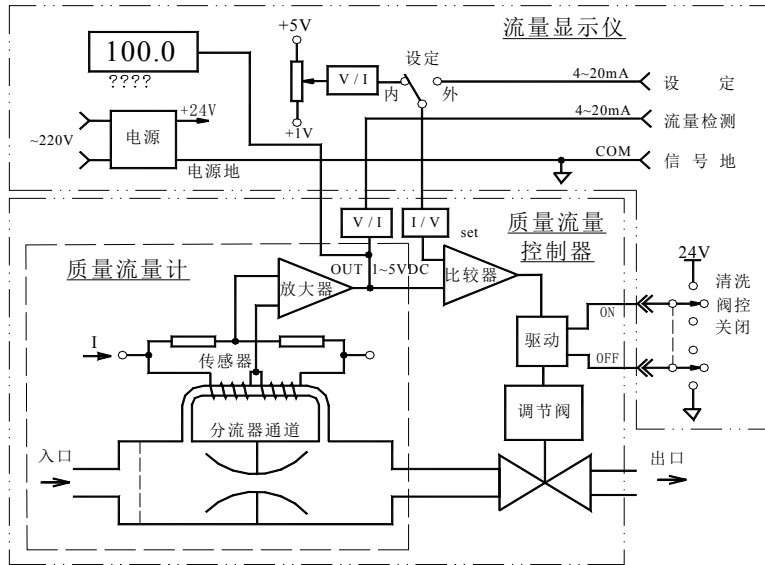
控制操作一般在流量显示仪上进行。当设定开关打到“内”设时，由设定电位器控制流量；当打到“外”设时，由用户提供的4~20mA(或 1~5VDC)设定信号控制流量。

在显示面板上还设置有三位阀门控制开关，当置为“关闭”位时，阀门关闭；当置为“清洗”位时，阀门开到最大，以便气路清洗，或作为流量计使用；当置于“阀控”时，质量流量控制器随设定信号自动控制流量。

4 安装和接线

4.1 外形及安装尺寸:

各型号产品的外形和安装尺寸如图 3a、3b、3c、3d 所示:



图 3a. D07-60G 质量流量控制器 1/2" 双卡套接头外形尺寸



法兰接头	D	K	L
DIN DN15- PN40	95	65	14
DIN DN20- PN40	105	75	14
DIN DN25- PN40	115	85	14

图 3b. D07-60G 质量流量控制器法兰接头外形尺寸

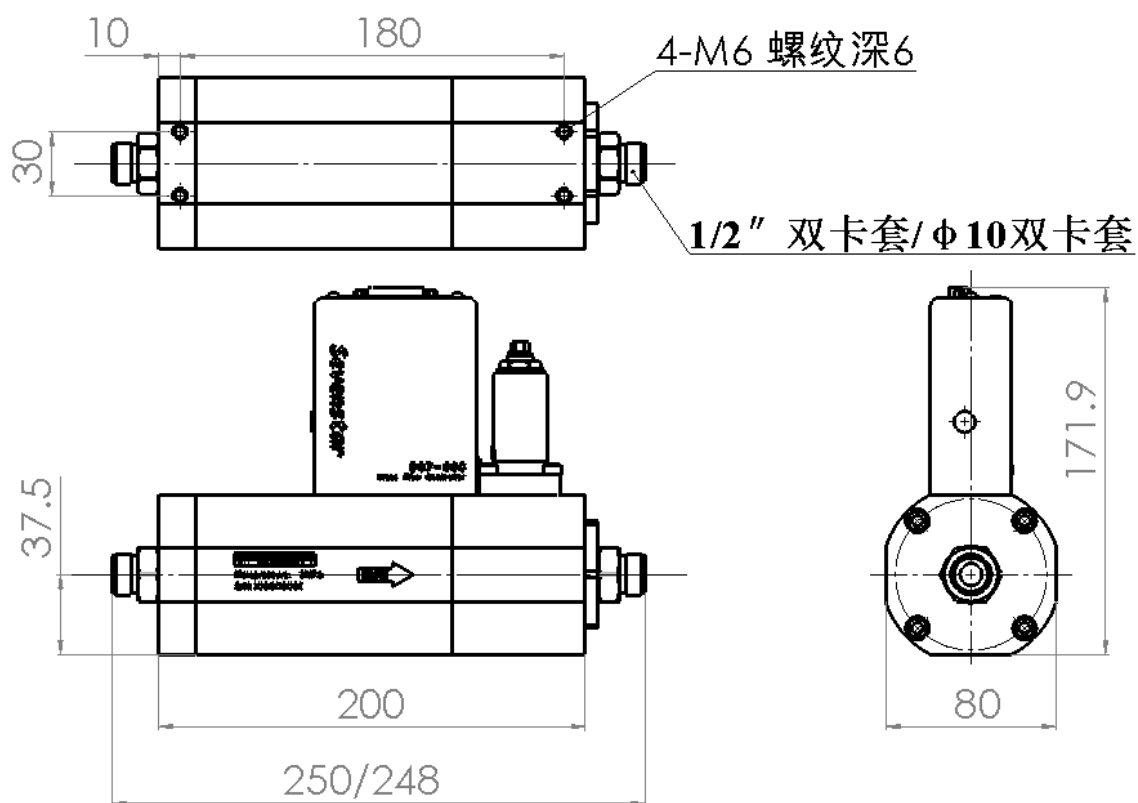
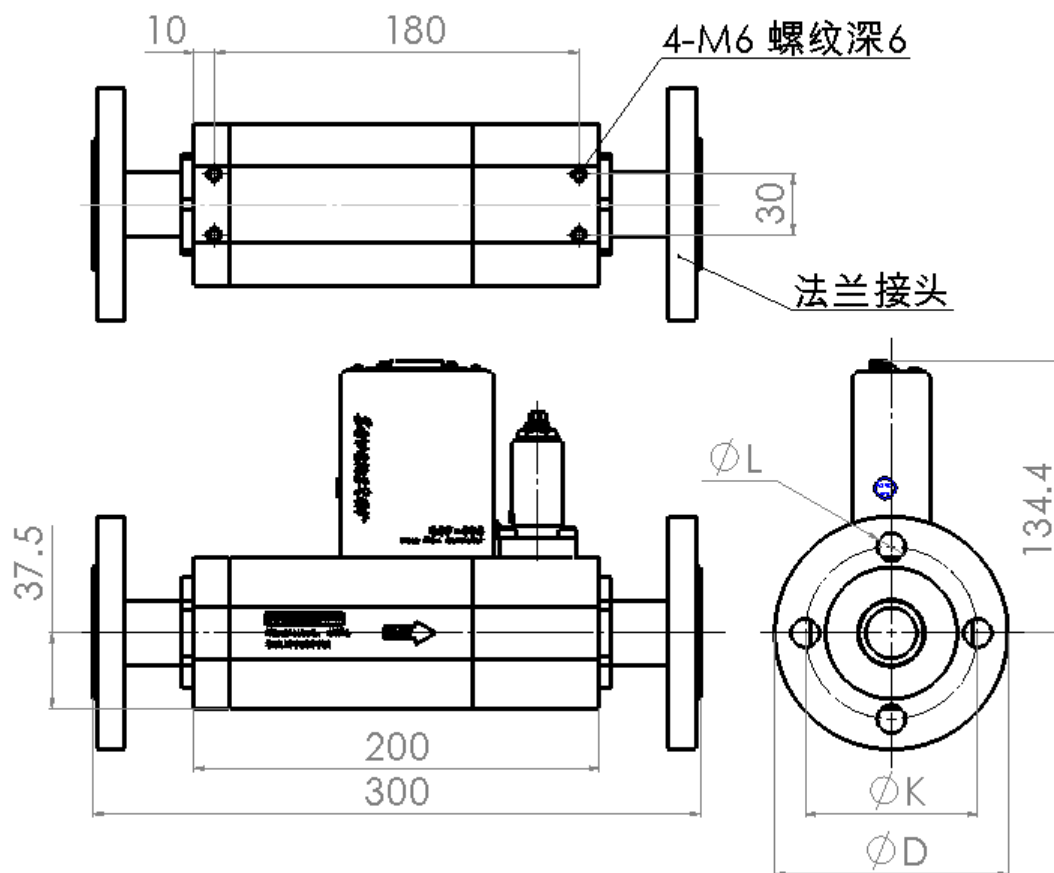

图 3c. D07-60GM 质量流量计 1/2" 双卡套接头外形尺寸



K、D、L 尺寸见图 3b 附表

图 3d. D07-60GM 质量流量计法兰接头外形尺寸

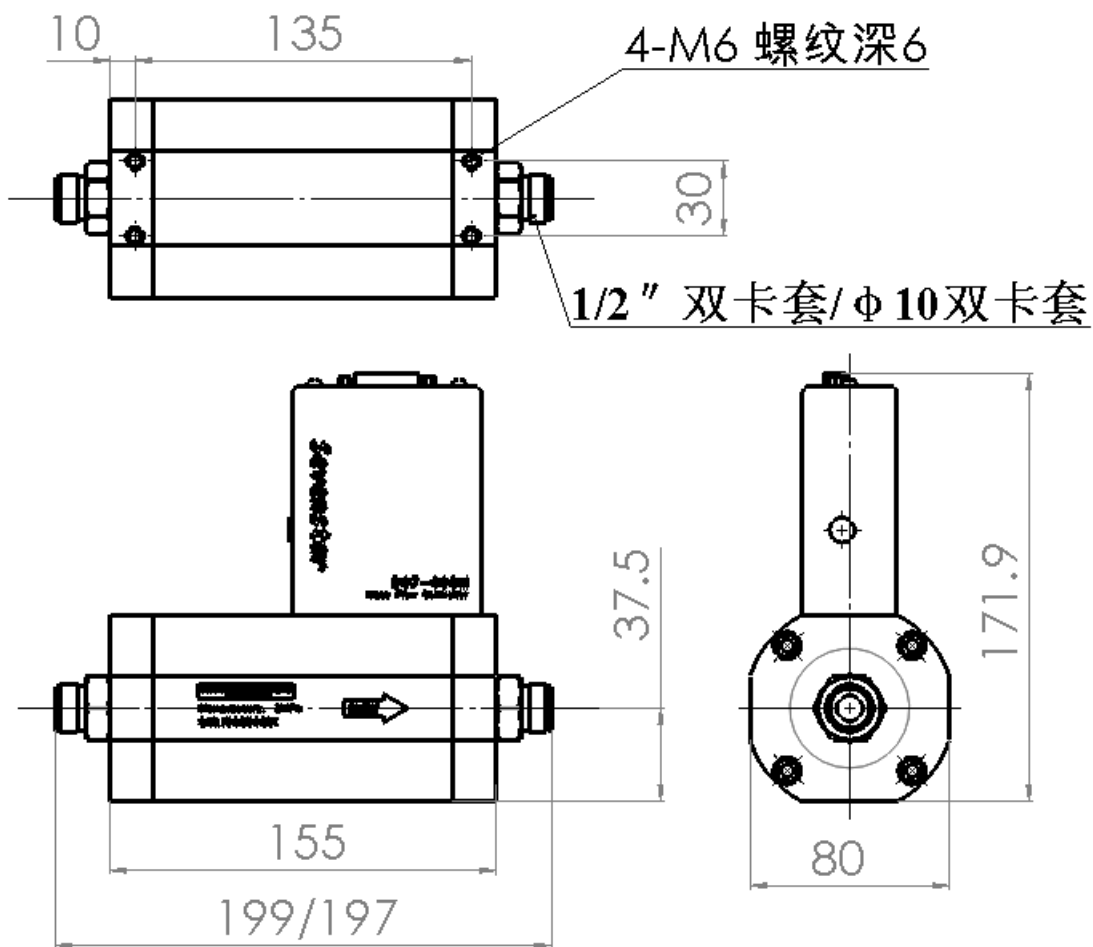
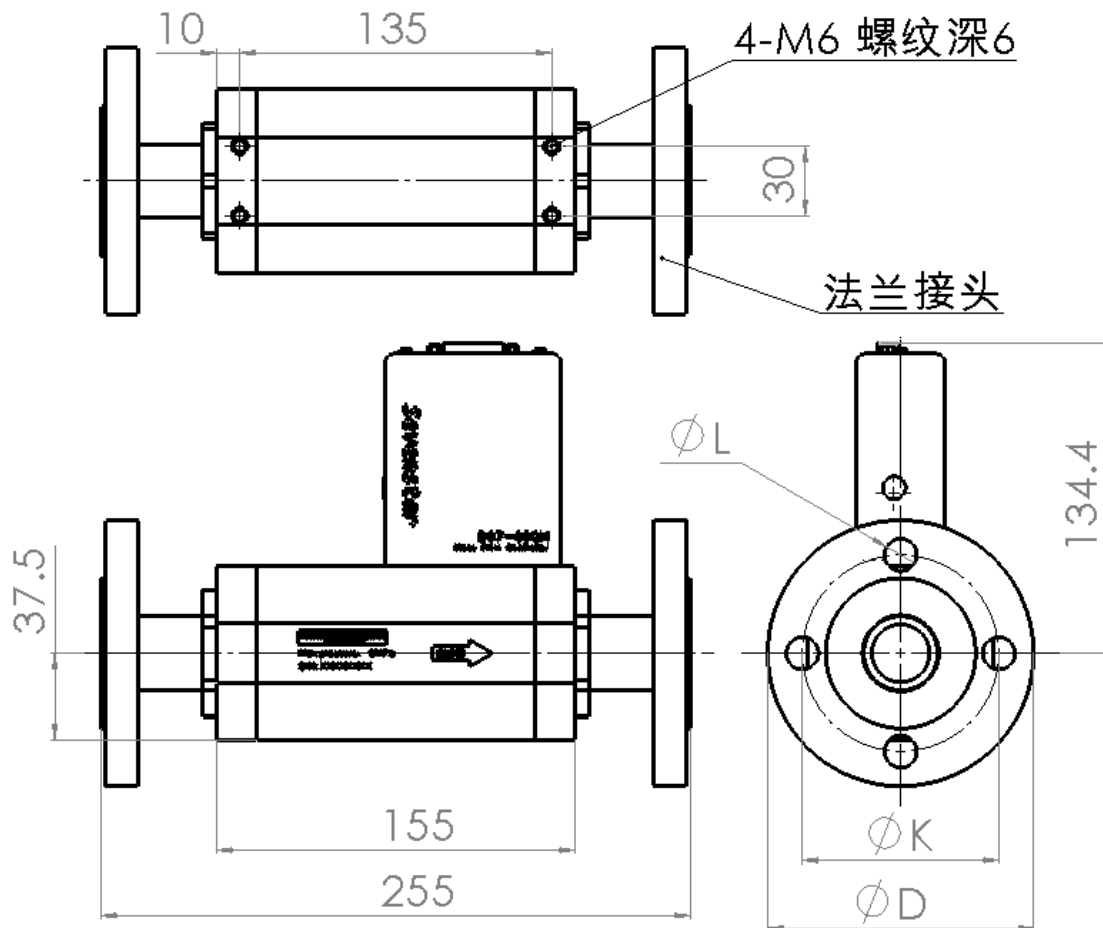
注意⚠:

以上各图中的高度 171.9 mm、134.4mm 是不加电缆插头的高度,加上插头后的高度要再增加 50mm 左右。

4.2 气路接头形式

可提供下列几种接头类型:

表 3. 接头规格一览表

型号	双卡套接头	法兰接头						
		DN15-P	DN20-PN	DN25-PN	DN15-P	DN15-P	DN25-PN	DN25-P
D07-60B /60BM	1/2" (F.S. ≤ 1000SLM)	N40 RF GB/T	40 RF GB/T	40 RF GB/T	N20 RF GB/T	N50 RF GB/T	20 RF GB/T	N50 RF GB/T
	φ 10 (F.S.= 300SLM)	9116.1 -2000	9116.1- 2000	9116.1- 2000	9116.1 -2000	9116.1 -2000	9116.1- 2000	9116.1 -2000

采用标准双卡套接头，一般用金属管将质量流量控制器与气路相连接，在要求不高的情况下也可以用尼龙管或其它较硬的弹性塑料管。双卡套接头的连接方法，如图 4 所示。注意流量计通道上的箭头指示的方向是气流方向，进出气方向不能接反。



图 4. 双卡套接头安装示意图

注意⚠:

按图 4 所示安装接管时,在装上前卡套、后卡套、螺母后,先用手将螺母与接头拧紧,再用扳手拧紧(国外进口的双卡套接头要求用扳手旋转 1.25 圈拧紧),以保证不漏气。注意应该使用双扳手操作,用一只扳手卡住接头不动,用另一只扳手旋转螺母。特别是在拆卸接管时必须使用双扳手操作,否则会引起接头松动,影响密封。

4.3 连接电缆插头

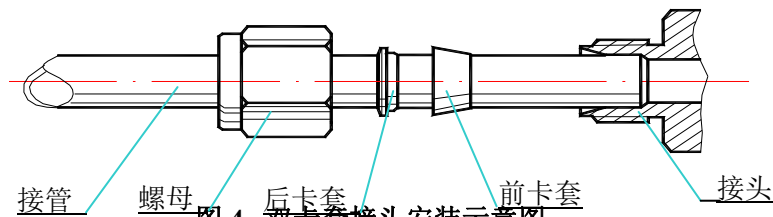
质量流量控制器通过专用电缆与配套流量显示仪连接后，即可通电通气工作。D07-60G 质量流量控制器的插座接线见图 5。



图 5. D07-60G 质量流量控制器接线图



图 6. D07-60GM 质量流量计的插座

4.4 与计算机或外部信号的连接

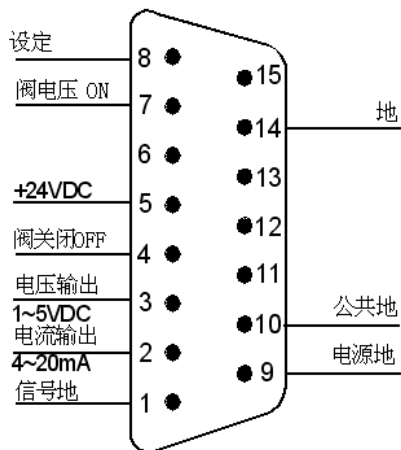
a. 质量流量控制器通过流量显示器与计算机(或其它外部信号)的连接方法, 见图 7。

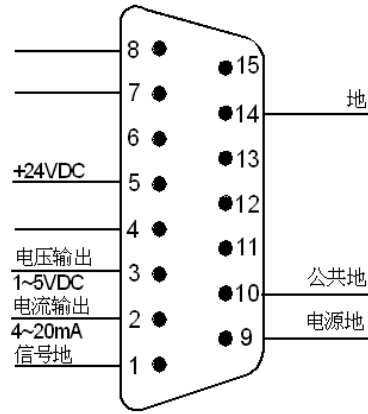

图 7. 通过流量显示器与计算机的连接

若用户要检测流量输出信号(4~20mA)时, 将线引至显示仪外控信号插座的“电流检测”和“信号地”(0 电平)线上即可, 也可直接与计算机的模数(A/D)转换器连接。注意, 如果MFC 是电压输出, +5.00V 输出电压对应 MFC 满量程额定流量值, 1V 对应零点, 流量检测输出电流不大于 3mA。

若流量设定使用外部信号, 应将设定选择开关打至“外”, 并从显示仪上的外控信号插座送入 4~20mA 电流信号 (或 1~+5.00V 外设电压)。也可直接与计算机的数模(D/A)转换器连接, 实现自动控制。

如果还需要计算机实现阀门的关闭功能, 可以用一个继电器的常开触点来实现。

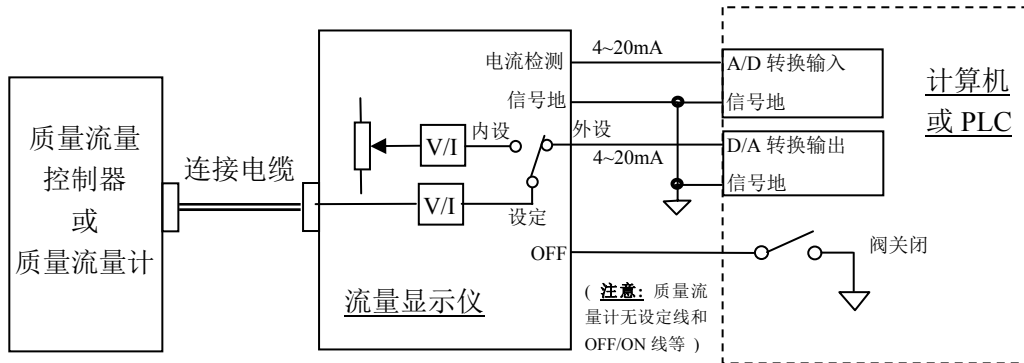
b. 质量流量控制器直接与计算机连接的接线方法, 见图 8。



图 8. 直接与计算机连接的接线方法

如果是 MFC/MFM 直接与计算机连接, 需要用户自己提供 24V 电源 (要求电源抗干扰能力要强); 将“设定”线接计算机 D/A 输出; 将“电流检测”线接计算机 A/D 输入端; “信号地”线接外部信号参考地; 小电流地线“公共地”和大电流地线“电源地”, 分别引线, 一起接在 24V 电源的公共端。

4.5 调零

首次使用或工作一段时间后,若发现零点偏移,可以调整。能通过外罩上进气口侧面的调零孔调整,也可揭开外罩调整。调整电位器位置示意如图9所示。注意:调零时流量管路不能通气(或将阀门关闭);必须在开机预热15分钟以上,待流量计零点稳定以后进行。通常除调零电位器外,其它电位器不得轻易调整。

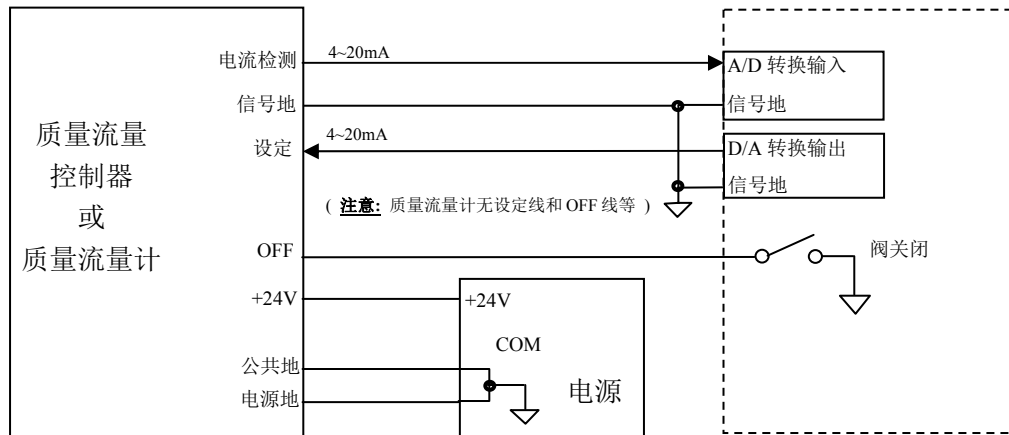

图 9. D07-60G、60GM 质量流量控制器/ 流量计调零电位器位置图

注意▲:

除调零电位器外,其他电位器用户不能轻易调整,以免影响精度。

5. 使用方法和操作步骤(结合 D08 系列流量显示仪)

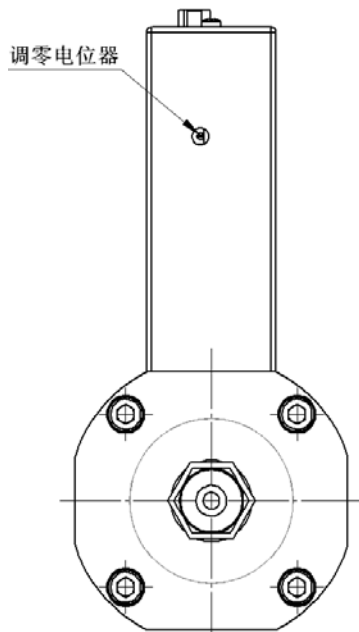
5.1 质量流量控制器的操作

5.1.1 开机操作

使用时主要操作在流量显示仪上进行(参见图 10)。阀门控制开关及流量设定电位器在前面板上，流量设定的内部或外部信号选择开关也在前面板上。当设定选择开关打到“内”时，用设定电位器设定流量，打到“外”时，由外部信号设定流量（参见 1K 型流量显示仪的使用说明书）。



图 10. 流量显示仪操作面板

- a. 阀开关处于“阀控”位时，先开气后开电源，则气体流量软启动经过约 20 秒钟达到原设定值的 5%以内。一般应先将阀关闭，不通气，通电预热 15 分钟，待零点稳定以后再正式工作。如果零点偏差较大，参见 4.5 条，在不通气情况下，可以通过调零电位器调零。
- b. 阀开关处于“关闭”位，通电预热 15 分钟后，开气，将阀开关置至“阀控”位，则流量经过几秒钟后达到设定流量的 2%以内。这是推荐操作方法。
- c. 阀开关处于“清洗”位，在开电源、开气后，则管路流量达到最大值，起到吹洗气路的作用。
- d. 阀开关处于“阀控”位，并且设定不为零时，如果先开电源，后开气，则流量将会有一个大过冲，然后迅速稳定至设定值。这种操作方法应当避免。
- e. 先开电源、将阀开关置到“关闭”位，将设定值调到零，再开气，待预热至零点稳定后，再转“阀控”位，然后将设定流量调至需要值，则实际流量跟踪设定值而改变，无过冲。这是最佳操作方法。

5.1.2 清洗功能

欲用气体吹洗管路，可将阀开关置为“清洗”位，清洗时的流量可达该控制器额定满量程流量的几倍至几十倍。如果不通气，则根据需要可以抽真空以排除质量流量控制器内部及其上游残存气体。然后将阀关闭，再开气，并转到“阀控”位工作。

5.1.3 显示仪与计算机连接的操作

参照图 1 和图 7，先将显示仪上的设定开关打到“外设”位，将阀控开关置于“阀控”位，再启动计算机程序进行工作。

5.1.4 与计算机直接连接的操作。

参照图 1 和图 8，在质量流量控制器预热稳定以后，即可启动程序进行工作。

5.1.5 阀门的清洗和关闭功能

参照图 2 和图 5，当 MFC 电缆中的“OFF”线接地时，阀门关闭；当 MFC 电缆中的“阀电压 (ON)”线接+24V 时，阀门开到最大，处于清洗状态；当“OFF”和“阀电压”线悬空时，阀门处于自动控制状态。注意应避免“OFF”和“阀电压”线同时动作，如果同时动作，MFC 将处于清洗状态。

5.1.6 关机操作

切断电源后，流量自动截止。最好先关气（将阀控开关置于“关闭”位和关闭气路中

的截止阀)，后断电源。

6. 注意事项

6.1 使用介质要求

所使用气体必须净化，切忌粉尘、液体和油污。必要时，须在气路中加装过滤器等。如果质量流量控制器出口接有液体源瓶，应在流量计出口加装单向阀，防止液体回流损坏流量计。

6.2 使用腐蚀性气体问题

质量流量控制器的气流通道中所采用的材料有： $00Cr_{17}Ni_{14}Mo_2$ （相当于 316L 不锈钢）， $1Cr18Ni9Ti$ （相当于 304 不锈钢），氟橡胶等耐蚀材料。在用户系统无水汽、低泄漏、勤清洗、使用得当的条件下，可以用于控制一般的腐蚀性气体。使用氨气、有机溶剂蒸汽（如丙酮等）、和其它强腐蚀性气体（如 BCl_3 、 BBr_3 等）的用户，应在定货时声明。对于 D07-60G 质量流量控制器所选用的非金属密封材料通常为氟橡胶或耐氨橡胶；对于使用特殊腐蚀性气体，所有密封材料都要作相应改变。

注意▲:

对于使用腐蚀性或有毒、易燃气体的产品，通气使用前应严格保证并检验安装和联接的气密性；如需从系统上卸下，应在断开气路前，使用干燥的对人体无害的常规气体（如氮气、空气）或惰性气体对产品进行彻底的清洗。如没有清洗，可能会引起火灾、爆炸、中毒等意外事故，将导致人员伤亡。

6.3 阀口密封问题

质量流量控制器的电磁阀是调节阀，不是截止阀，不能当截止阀使用，用户应另配截止阀。特别是用户如果使用腐蚀性气体，通常应该在质量流量控制器进出气口各加一个截止阀，以保证工作安全。长期工作后，如果控制器阀口的漏气率在 2%F.S.以内，是属于正常情况。如果漏气大于满量程的 2%，则应进行维修。

6.4 阀控操作注意

在操作阀门进行“清洗”后，不得直接转至“阀控”位工作，必须先将阀门置至“关闭”位，然后再转至“阀控”位工作。

6.5 安装位置问题

本质量流量控制器安装时最好保持安装面水平，但对位置并不特别敏感，可以任意位置安装，非水平位安装时若发现零点偏移，可调整零点后再工作。如果用户订货时注明安装位置，我厂也可根据用户的安装位置进行标定后出厂。

6.6 注意工作压差

质量流量控制器要特别注意工作介质的气压，应注意使控制器进出气口两端的工作压差保持在指标范围之内。特别是在高压下工作时，气压差过大，流量将无法关闭或调小。在使用大流量的质量流量控制器时，要注意适当加粗管道和减小气源内阻，若工作压差小于要求值，有可能流量达不到满量程值。

6.7 标定和不同气体的换算

本流量计出厂通常用氮气（N₂）标定。如果要求用使用气体标定，需要在订货时与销售人员进行特别申明。

用氮气标定的流量计用户使用其它气体时，可以通过附录 9.1 的转换系数进行换算，算出被使用气体的流量。将质量流量控制器显示出的流量读数，与某使用气体的转换系数相乘，即得该被测气体在标准状态下的质量流量。

例如：一个出厂标定为 1000 SLM(N₂) 的质量流量控制器，通甲烷气体时显示的流量为 860 SLM，从附录 9.1 查得甲烷的转换系数为 0.719，则甲烷的实际流量为 860×0.719 即 618.3 SCCM。

如果用户使用混合气体，可以通过附录 9.2 介绍的方法，计算出混合气体的转换系数。

6.8 D07-60G、60GM 标准订单填写格式

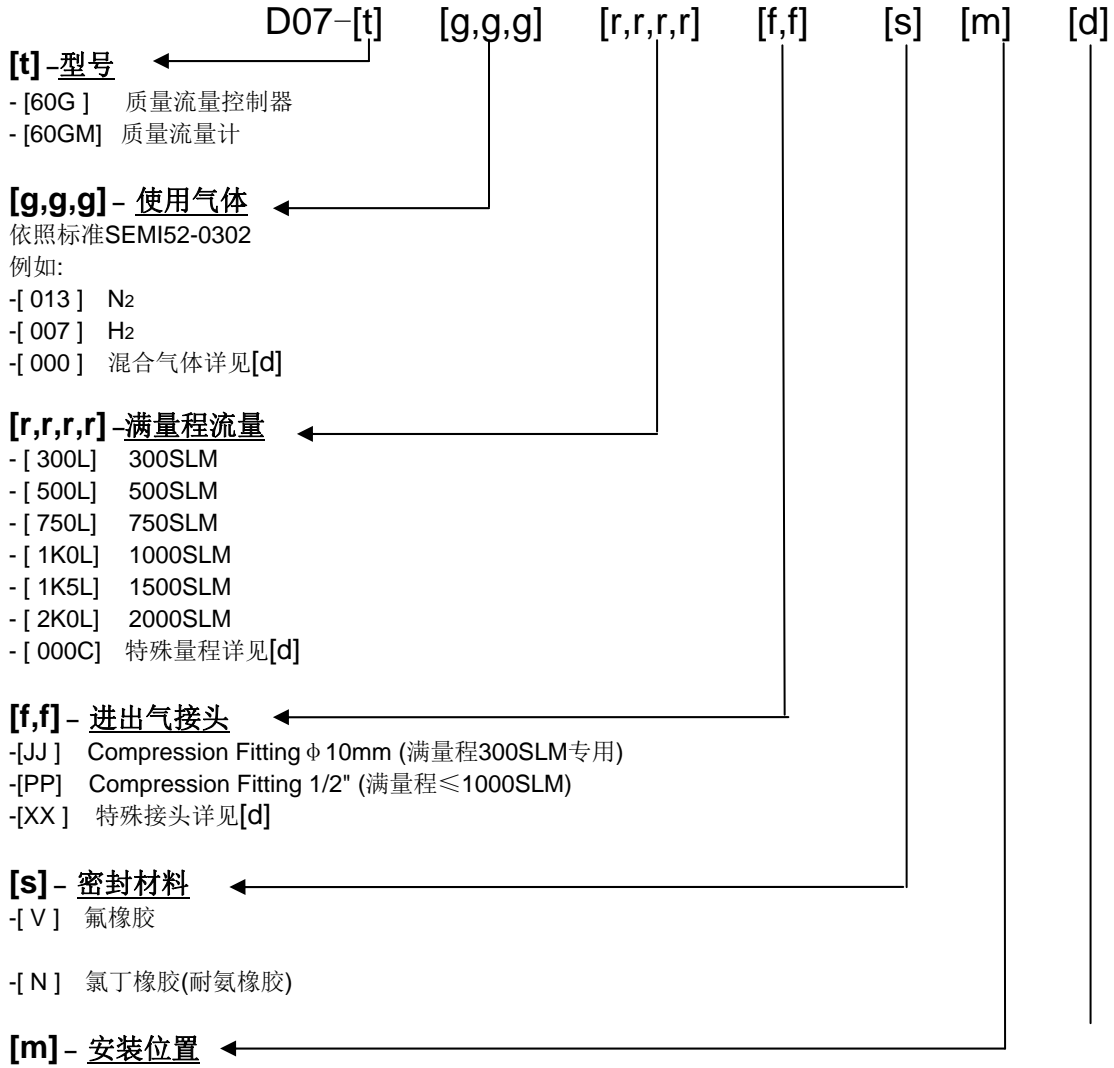

- [H] 水平安装
- [E] 平躺安装
- [U] 进气口向上垂直安装
- [D] 进气口向下垂直安装

[d] - 其它说明

-[] 出厂默认:

外罩及标签文字: 中文

工作压差范围: D07-60G: $\leq 1000\text{SLM}$ (0.25 ~ 0.5) MPa (36.25~72.5 psid)
 $> 1000\text{SLM}$ (0.4 ~ 0.6) MPa (58~72.5 psid)

D07-60GM: $< 0.2\text{MPa}$ (29psid)

耐压: 3 MPa (435.1 psig)

标定温度: (22±2)°C

-[S] 特殊要求:

例如: 外罩及标签文字: 英文; 特殊量程:1900SLM; 混合气体要注明比例: N₂ (60%) + CO₂(40%);
工作压差范围: (0.2~ 0.3) MPa; 标定温度: 40°C及其它特殊要求等。

举例:

以 D07-60G013500LPPVHS 为例:

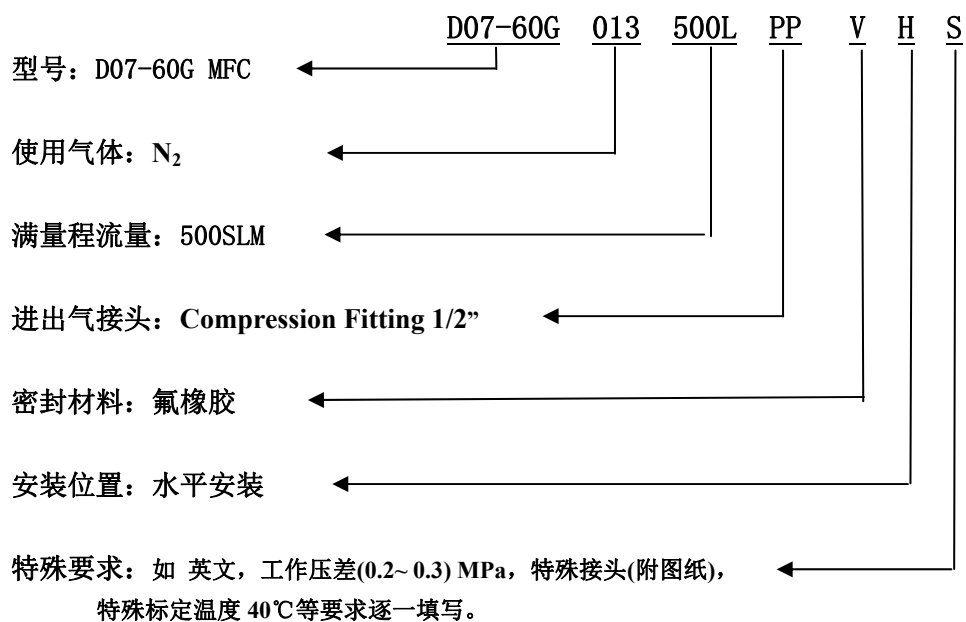

7. 故障判断和处理

表 3. 故障判断和处理一览表

序号	故障现象	故障可能原因	处理方法
1	开机后, 无气流流过	1.1 气源未开, 气路不通	接通气源, 开通气路
		1.2 阀控开关关闭	将阀开关置于"阀控"位或"清洗"位
		1.3 无设定信号	检查设定电位器和"内外"设定开关的状态等
		1.4 过滤器堵塞	*更换过滤器
		1.5 调节阀故障	检查阀线包是否断, *清洗调节阀
		1.6 电路故障	*维修电路
2	开机不通气的情况下, 流量检测不正常	2.1 零点偏差	调整调零电位器
		2.2 电源故障	*检查±15V 电源等
		2.3 传感器故障	*更换传感器
		2.4 运算放大器或其它电路故障	*更换运放, 维修电路
3	在阀门关闭的情况下, 仍有较大的流量流过	3.1 入口气压过高, 进出气口之间的压差超过额定值	适当降低输入气压, 减小气压差
		3.2 阀门污染	*清洗阀门, 更换密封件
		3.3 调节阀故障	*重新调整调节阀
4	流量显示不能达到满量程值	4.1 气压降低于额定值	提高入口气压
		4.2 通道堵塞	*清洗 MFC 通道
		4.3 设定电压低于 5.00V	*检查设定电压
		4.4 其它电路故障	*维修电路

续表 3. 故障判断和处理一览表

序号	故障现象	故障可能原因	处理方法
5	气流控制不稳定,有较大的波动	5.1 气源压强太低或不稳	提高气源气压, 稳定气源压强
		5.2 气源内阻过大	降低气源内阻 (大流量时要注意开大阀门, 加粗管道, 以至并联气瓶, 提高气源供气能力)
		5.3 电路或调节阀故障	*维修调整
6	使用高频源时流量控制器受干扰	6.1 供电系统的地线和零线连接或机壳接地有问题	检查接地系统, 注意一点接地
		6.2 信号参考端连接问题	检查信号连接线
		6.3 空间干扰	适当屏蔽, 远离干扰源, 选用屏蔽线
7	实际流量与显示流量不一致	7.1 显示器量程或单位与控制器不匹配	*重调显示器
		7.2 控制器通道被污染, 引起流量精度发生偏差	*对控制器进行清洗标定
		7.3 流量计零点有较大漂移, 不稳定	*更换传感器, 维修电路
8	设定为零时仍有流量流过	8.1 调节阀漏气	*维修调节阀
		8.2 流量计零点偏负	将流量计零点调为零或偏正
9	通道有很大气流流过, 而输出无流量显示	9.1 传感器堵塞	*维修更换传感器 气源有粉尘, 应在通道前加装过滤器。若使用硅烷等特殊气体, 应注意管路的密封性和气源干燥
		9.2 电路故障	*维修电路
10	不通气时, 发现零点不稳, 或零点长时间慢漂移	10.1 传感器故障	*更换传感器

注意▲:

标*号的项目必须由专业维修人员进行修理。

8. 保证、保修与服务

8.1 产品保证和保修

- 8.1.1 本公司生产的MFC/MFM产品在出货两年以内，如果用户按照说明书要求使用，并且产品没有遭受物理损害、污染、改装或翻新，我们保证产品的材料、加工和性能的质量，若有问题，免费维修。
- 8.1.2 用户收到货物后，有责任检查及核对货物，并通过传真、电话或电子邮件的方式及时通知本公司销售部有关收货情况。
- 8.1.3 保修期内，产品必须由本公司或授权的服务中心修理，否则，产品的保修是无效的。
- 8.1.4 在两年保修期以内，维修是免费的。如果保修期过了，在维修前将会通知用户需要更换的部件及维修费用。维修后，在90天以内对修理的部分进行保修，保修件包括易损件（四氟或密封圈等）。
- 8.1.5 用户使用过有毒、有污染或腐蚀性气体的产品，如果没有出示清除污染及净化处理的证明，本公司将不负责修理或保修。

8.2 保修对使用的要求

- a. 气体必须洁净且没有颗粒物，没有液体，这就要求在MFC/MFM的上游气路中安装 $<30\mu\text{m}$ 的过滤器。
- b. 输入的气体压力必须符合产品的耐压标准，不能超过该产品要求的最大压力。
- c. 产品的使用气体必须与用户订货选择的密封材料相适应，用户有责任按照可用的安全规章使用每种气体。不正确的使用产品会使保修无效，由于不正确的使用所导致的损害不能归咎于本公司。
- d. 对电子线路的要求：必须小心按规定连接系统的接线，不正确的接线会导致产品内部电路板的永久损坏。若自备MFC电源，需要电压波动小于5mV的高抗干扰稳压电源。
- e. 气路的连接：必须仔细的安装密封管件，保证所有的密封管件经过单独检查并且没有划痕。
- f. 禁止自行拆开MFC/MFM。如果自行拆卸造成损坏，则本公司承诺的保修无效。

8.3 服务

本公司的产品工程师将会帮助您解决关于操作、标定、机电连接、工作条件要求、气体

转换等方面的问题。我们提供技术支持与维护, 提供产品的使用培训。

请您访问 www.mfcsevenstar.cn 找到有关的产品资讯和离您最近的维修及服务中心。

9. 附录

9.1 气体质量流量转换系数:

表 5. 气体质量流量转换系数表

气 体	代号(SEMIE52-0302)	比热(卡/克°C)	密度(克/升 0°C)	转换系数
Air 空气	008	0.2400	1.2930	1.006
Ar 氩气	004	0.1250	1.7837	1.415
AsH ₃ 砷烷	035	0.1168	3.4780	0.673
BBr ₃ 三溴化硼	079	0.0647	11.1800	0.378
BCl ₃ 三氯化硼	070	0.1217	5.2270	0.430
BF ₃ 三氟化硼	048	0.1779	3.0250	0.508
B ₂ H ₆ 硼烷	058	0.5020	1.2350	0.441
CCl ₄ 四氯化碳	101	0.1297	6.8600	0.307
CF ₄ 四氟化碳	063	0.1659	3.9636	0.420
CH ₄ 甲烷	028	0.5318	0.7150	0.719
C ₂ H ₂ 乙炔	042	0.4049	1.1620	0.581
C ₂ H ₄ 乙烯	038	0.3658	1.2510	0.598
C ₂ H ₆ 乙烷	054	0.4241	1.3420	0.481
C ₃ H ₄ 丙炔	068	0.3633	1.7870	0.421
C ₃ H ₆ 丙烯	069	0.3659	1.8770	0.398
C ₃ H ₈ 丙烷	089	0.3990	1.9670	0.348
C ₄ H ₆ 丁炔	093	0.3515	2.4130	0.322
C ₄ H ₈ 丁烯	104	0.3723	2.5030	0.294
C ₄ H ₁₀ 丁烷	111	0.4130	2.5930	0.255
C ₅ H ₁₂ 戊烷	240	0.3916	3.2190	0.217
CH ₃ OH 甲醇	176	0.3277	1.4300	0.584
C ₂ H ₆ O 乙醇	136	0.3398	2.0550	0.392
C ₂ H ₃ Cl ₃ 三氯乙烷	112	0.1654	5.9500	0.278
CO 一氧化碳	009	0.2488	1.2500	1.000
CO ₂ 二氧化碳	025	0.2017	1.9640	0.737
C ₂ N ₂ 氰气	059	0.2608	2.3220	0.452
Cl ₂ 氯气	019	0.1145	3.1630	0.858
D ₂ 氘气	014	1.7325	0.1798	0.998
F ₂ 氟气	018	0.1970	1.6950	0.931
GeCl ₄ 四氯化锗	113	0.1072	9.5650	0.267

续表 5. 气体质量流量转换系数表

气 体	代号(SEMIE52-0302)	比热(卡/克℃)	密度(克/升 0℃)	转换系数
GeH ₄ 锗烷	043	0.1405	3.4180	0.569
H ₂ 氢气	007	3.4224	0.0899	1.010
HBr 溴化氢	010	0.0861	3.6100	1.000
HCl 氯化氢	011	0.1911	1.6270	1.000
HF 氟化氢	012	0.3482	0.8930	1.000
HI 碘化氢	017	0.0545	5.7070	0.999
H ₂ S 硫化氢	022	0.2278	1.5200	0.844
He 氦气	001	1.2418	0.1786	1.415
Kr 氪气	005	0.0593	3.7390	1.415
N ₂ 氮气	013	0.2486	1.2500	1.000
Ne 氖气	002	0.2464	0.9000	1.415
NH ₃ 氨气	029	0.5005	0.7600	0.719
NO 一氧化氮	016	0.2378	1.3390	0.976
NO ₂ 二氧化氮	026	0.1923	2.0520	0.741
N ₂ O 一氧化二氮	027	0.2098	1.9640	0.709
O ₂ 氧气	015	0.2196	1.4270	0.992
PCl ₃ 三氯化磷	193	0.1247	6.1270	0.358
PH ₃ 磷烷	031	0.2610	1.5170	0.691
PF ₅ 五氟化磷	143	0.1611	5.6200	0.302
POCl ₃ 三氯氧磷	102	0.1324	6.8450	0.302
SiCl ₄ 四氯化硅	108	0.1270	7.5847	0.284
SiF ₄ 四氟化硅	088	0.1692	4.6430	0.348
SiH ₄ 硅烷	039	0.3189	1.4330	0.599
SiH ₂ Cl ₂ 二氯氢硅	067	0.1472	4.5060	0.412
SiHCl ₃ 三氯氢硅	147	0.1332	6.0430	0.340
SF ₆ 六氟化硫	110	0.1588	6.5160	0.264
SO ₂ 二氧化硫	032	0.1489	2.8580	0.687
TiCl ₄ 四氯化钛	114	0.1572	8.4650	0.206
WF ₆ 六氟化钨	121	0.0956	13.2900	0.215
Xe 氙气	006	0.0379	5.8580	1.415

9.2 转换系数使用说明

质量流量控制器、质量流量计出厂时一般用 N₂ 标定，实际使用中如果是其它气体，必要时可进行读数修正，方法是以流量显示仪显示的流量乘以流量转换系数。如是单组份气体，其转换系数可在我厂产品技术说明书中查得，也可以根据下面的基本公式计算；如是多组份气体（假定由 n 种气体组成），请按下列混合气体公式计算其转换系数 C：

基本公式： $C=0.3106 N / \rho (Cp)$

其中： ρ ——为气体在标准状态下的密度

CP——为气体的定压比热

N——为气体分子构成系数（与该气体分子构成的组份有关，见下表）

气体分子构成系数表：

气体分子构成	举	例	N 取值
单原子分子	Ar	He	1.01
双原子分子	CO	N ₂	1.00
三原子分子	CO ₂	NO ₂	0.94
多原子分子	NH ₃	C ₄ H ₈	0.88

对于混合气体： $N=N_1(\omega_1/\omega_T)+N_2(\omega_2/\omega_T)+\dots+N_n(\omega_n/\omega_T)$

导出公式：

$$C = \frac{0.3106 [N_1(\omega_1/\omega_T)+N_2(\omega_2/\omega_T)+\dots+N_n(\omega_n/\omega_T)]}{\rho_1 Cp_1(\omega_1/\omega_T)+\rho_2 Cp_2(\omega_2/\omega_T)+\dots+\rho_n Cp_n(\omega_n/\omega_T)}$$

其中： $\omega_1 \dots \omega_n$ ——为相应气体的流量

ω_T ——为混合气体的流量

$\rho_1 \dots \rho_n$ ——为相应气体在标准状态下的密度（数值见气体转换系数表）

$CP_1 \dots CP_n$ ——为相应气体的定压比热（数值见气体转换系数表）

$N_1 \dots N_n$ ——为相应气体的分子构成系数，取值见气体分子构成系数表

说明：

1) 标准状态为：压力—101325Pa (760 mm Hg)，温度—273.15K (0℃)。

2) 气体质量流量转换系数表中未列出的气体的有关参数，可以向我们咨询。

D07 系列

质量流量控制器

北京七星华创电子股份有限公司

质量流量计分公司

(北京七星弗洛尔电子设备制造有限公司制造)

地 址: 北京市朝阳区酒仙桥东路 1 号
通讯地址: 北京 741 信箱 3 分箱
邮政编码: 100015
联系电话: +86-10-64362939 64362925
传 真: +86-10-64362923
网 址: www.mfcsevenstar.cn
电子信箱(E-mail): mfcsales@sevenstar.com.cn
乘车路线: 乘地铁到东直门, 换乘 401 路公共汽车, 到陈各庄下车或
乘地铁到农业展览馆, 换乘 516 路公共汽车, 到酒仙桥东路北口下车

上海办事处: 上海市浦东新区张江路 368 号 29 号楼 722 室
电 话: +86-21-63532370
传 真: +86-21-63533265

深圳办事处: 深圳市福田区振华路 45 号汽车大厦 B712 (518031)
电 话: +86-755-88290258
传 真: +86-755-88294770

*公司承诺不断提升产品品质, 保留在不经通知的情况下对此手册所含信息进行修改的权力。

*本手册内容, 已经严格审校, 如有错误或遗漏, 请及时告知。

*七星电子 版权所有

D07 – 60G	Mass Flow controller
D07-60GM	Mass Flow Meter

INSTRUCTION MANUAL



北京七星华创电子股份有限公司
BEIJING SEVENSTAR ELECTRONICS CO., LTD.

2015 . 12



A NOTE TO OUR CUSTOMERS

The Sevenstar D07 series Mass Flow Meter/Controller you have just received is of the leading quality available. It includes excellent high degree of accuracy and repeatability, in addition to the variety of operation pressure available. It offers soft-start, tightly controlled response and maximum applications flexibility.

We strongly recommend that you read this manual thoroughly before performing any operation. This manual will enable the full information necessary for installation, operation and ease of maintenance to be realized.

Should you require any additional information concerning the Sevenstar D07 series Mass Flow Controller or Mass Flow Meter, please feel free to contact your local Sevenstar Sales Agent or Sevenstar Customer Service at: (8610)--- 6436 2939.

We appreciate this opportunity to service your Mass Flow Meter/Controller, and hope we will be able to provide you with further assistance in future.

Yours sincerely,
Sevenstar

目 录

1. APPLICATION & FEATURES.....	1	5.2.2 Zero Test and Adjustment.....	16
2. SPECIFICATION.....	2	5.2.3 Gas Supply.....	16
3. STRUCTURE & PRINCIPLE.....	3	5.2.4 Shut Off.....	16
3.1 Structure.....	3	6. CAUTION.....	16
3.2 Operation Principle.....	3	6.1 Medium Forbidden	16
4. INSTALLATION & CONNECTION	5	6.2 Corrosive Gas	16
4.1 Dimension.....	5	6.3 Valves Dynamic Sealing	17
4.2 Fittings.....	9	6.4 Valves Operating	17
4.3 Electrical Interfacing.....	10	6.5 Installation Position	17
4.4 PC Connection.....	11	6.6 Operation Pressure Resistance.....	17
4.5 Zero Adjustment.....	13	6.7 Calibration and Conversion.....	17
5. OPERATION INSTRUCTIONS.....	14	6.8 D07-60G, 60GM Ordering Code.....	18
5.1 MFC Operation.....	14	7. TROUBLESHOOTING.....	21
5.1.1 Start Up.....	14	8. WARRANTY & SERVICE.....	23
5.1.2 Purge.....	15	8.1 Product Warranty.....	23
5.1.3 Readout Box & PC Connection.....	15	8.2 Specific warranty requirements	23
5.1.4 PC Connection.....	15	8.3 Service.....	23
5.1.5 Valves Control.....	15	9. APPENDIX.....	24
5.1.6 Shut Off Operation.....	15	9.1 Mass Flow Conversion factors.....	24
5.2 MFM Operation.....	16	9.2 Conversion factors Introduction.....	26
5.2.1 Start Up	16		

MASS FLOW CONTROLLER & MASS FLOW METER

Operating Instruction

1. APPLICATION & FEATURES

Mass Flow Meter (**MFM**) accurately measures mass flow rates, Mass Flow Controller (**MFC**) accurately measures and controls mass flow rates despite gas volume fluctuation due to pressure or temperature changes. They are widely applied in the fields as: semiconductor and IC fabrication, special materials science, chemical industry, petrolic industry, pharmaceutical industry, environmental protection and vacuum system researching, etc. The typical applications include: microelectronic process equipment such as diffusion, oxidation, epitaxy, CVD, plasma etching, sputtering, ion implantation; vacuum deposition equipment, optical fiber melting, micro-reaction equipment, mixing & matching gas system, capillary flow control system, gas chromatograph and other analytical instruments.

D07 series MFM & MFC bring the high accuracy, excellent repeatability, quick response, soft-start, better reliability, wide variety ranges of operation pressure (good operation in high pressure and vacuum situations), simple convenient operation, flexible installation, possible connecting with PC to carry out automatic control to the users' system.

D07-60G、D07-60GM all use 24 VDC power supply, and they are better connected together with D08-1K Readout Box, the cable connection is showing as following (Figure 1):



Figure 1 D07-60G MFC and Readout Box

2. SPECIFICATION

Table 1. Specifications of D07-60G MFC and D07-60GM MFM

NO	Item	D07-60G	D07-60GM
1	Flow Ranges	300, 500, 750, 1000, 1500, 2000SLM	
2	Accuracy	± 2% F.S.	
3	Linearity	±1% F.S.	
4	Repeatability	±0.2%F.S.	
5	Response-Time	< 10 sec	
6	Operation Pressure	(0.25 ~ 0.5) MPa (≤1000SLM) (0.4 ~ 0.6) MPa (>1000SLM)	<0.2 MPa
7	Max Pressure	3 MPa	
8	Operation Temperature	5~ 45 °C	
9	Input Signal	4~20 mA or 1~5 VDC	NO
10	Output Signal	4~20 mA or 1~5 VDC	
11	Valve Type	N.C. Solenoid	NO
12	Power Supply	+24VDC 400 mA	+24VDC 400 mA
13	Dimension (mm)	According to Figure 3a, 3b, 3c, 3d	
14	Weight (kg)	6	5

Notes▲:

MFC/MFM is calibrated by N₂ as a standard gas.

Units: SCCM (Standard Cubic Centimeter/Min);
 SLM (Standard Liter/Min)

Standard Situation: Tem — 273.15K (0 °C);
 Air Pressure — 101325 Pa (760mm Hg)

For Sevenstar MFC/MFM, the unit of SCCM is identical to “mL/min, 0 °C ,1atm”, and the unit of SLM

is identical to “L/min, 0 °C ,1atm”.

F.S. : Full Scale

3. STRUCTURE & OPERATION PRINCIPLE

3.1 Structure

The MFM consists of flow sensor, flow-splitter bypass and flow amplifying circuit. If add Control valves and PID control circuit to MFM will compose a MFC.

3.2 Operation Principle

According to the Capillary Heat Transfer Temperature Difference Calorimetry Theory, the flow sensor measures the mass flow without pressure compensation. The sensor heated the flow signal which was measured by electric bridge and amplified it through amplifier, the amplified flow testing voltage is compared with presetting voltage, the differential signal will control valve after amplified, then the flow rate of closed loop control will be as same as presetting flow rate. The bypass divider controls the flow rate. The corresponding D08 series Flow Readout Boxes have stabilized power supply, 3 and 1/2 digital voltage meter, presetting potentiometer, external & internal converters and three-phase switches. Figure 2 is exactly showing the operating principle while MFC is connecting with Flow Readout Box.

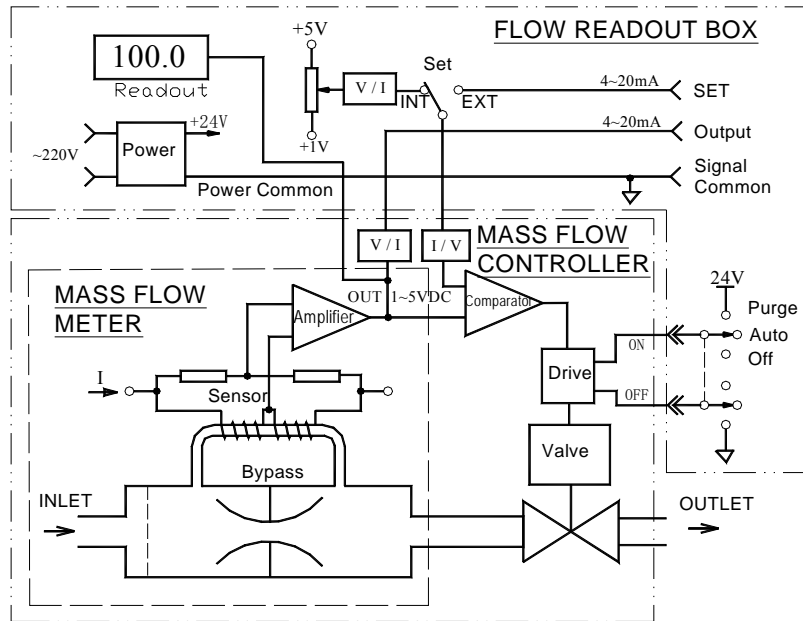

Figure2. Principle of MFC

The outputting flow testing signal from MFC is a direct ratio with the flow through the channels, flow outputting signal is 4~20mA (or 1~5VDC). The Flow control ranges of MFC is (2~100)% F.S.. When the set point <2% F.S. the valve will shut off. MFC and MFM flow resolving power is 0.1% F.S..

Attention:

When Valve controller of MFC is posited on position of "PURGE", it can be functioned as a MFM. In that case, the maximum flow testing voltage could reach beyond +10V, please be careful, while flow is beyond F.S. +5V(Full Scale), the real flow will have no linearity corresponding with flow testing voltage. While it's purging, flow display will be inaccurate, even showing "reduce" while the real flow is enhanced, please be sure it'll be no damaged to device itself.

Operation control could accomplish by Flow Readout Box. When set point is turned on the “INT”, flow rate will be under controlled by the presetting potentiometer; when setpoint is turned on the “EXT”, flow rate will be controlled by set signal which is supplied by users.

There are three valves control switches on the panel of D08 series Flow Readout Box: CLOSE, PURGE and AUTO. In case of CLOSE, Valves of MFC will shut off; in case of PURGE, Valve will open reach to the tip to purge the Gas systems or could be functioned as a MFM; when set to AUTO, Valve can control the flow rate automatically.

4. INSTALLATION & CONNECTION

4.1 Dimension

Dimensions and installations are showing as following figure 3a、3b、3c、3d:

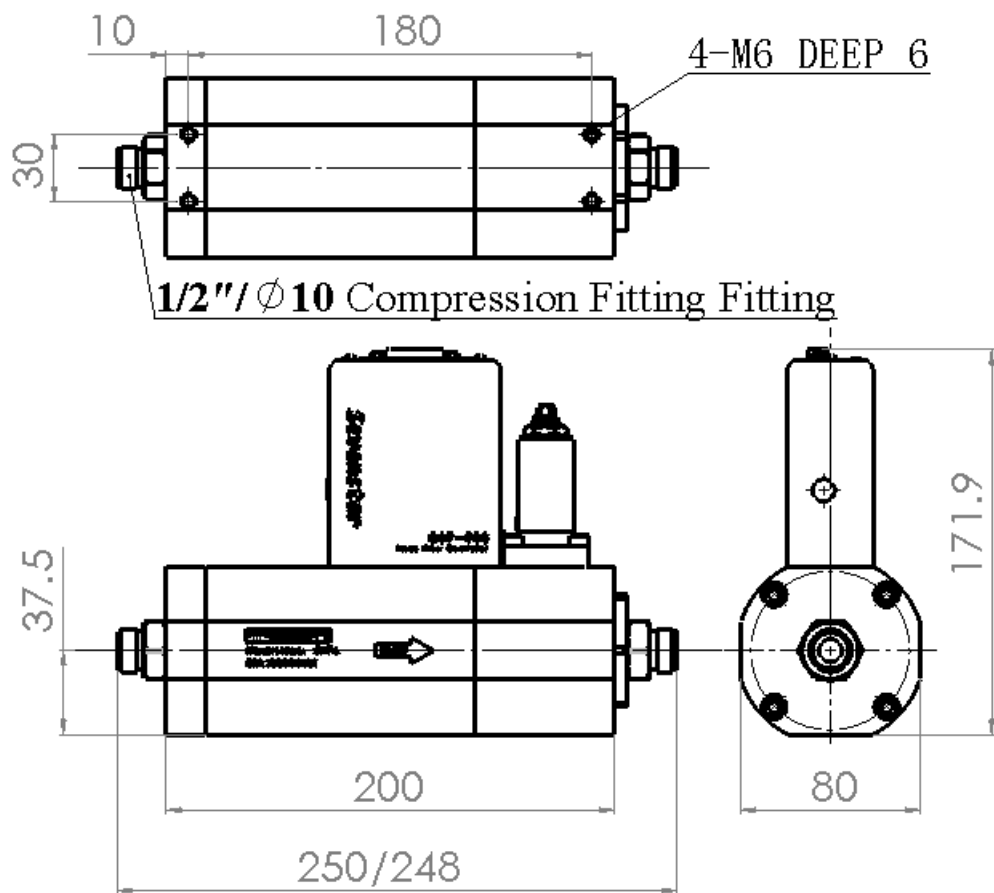
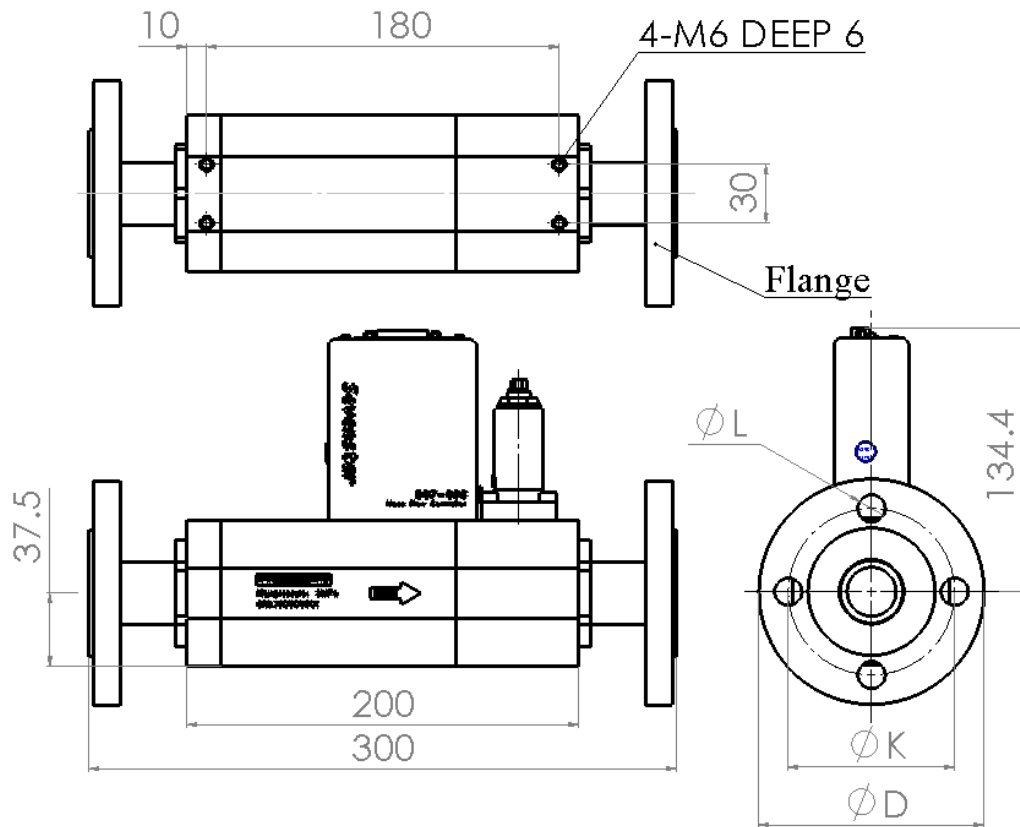

Figure 3a. Dimension of D07-60G MFC With 1/2" / φ 10 Compression Fitting Fitting



Flange	D	K	L
DIN DN15- PN40	95	65	14
DIN DN20- PN40	105	75	14
DIN DN25- PN40	115	85	14

Figure 3b. Dimension of D07-60G MFC With Flange

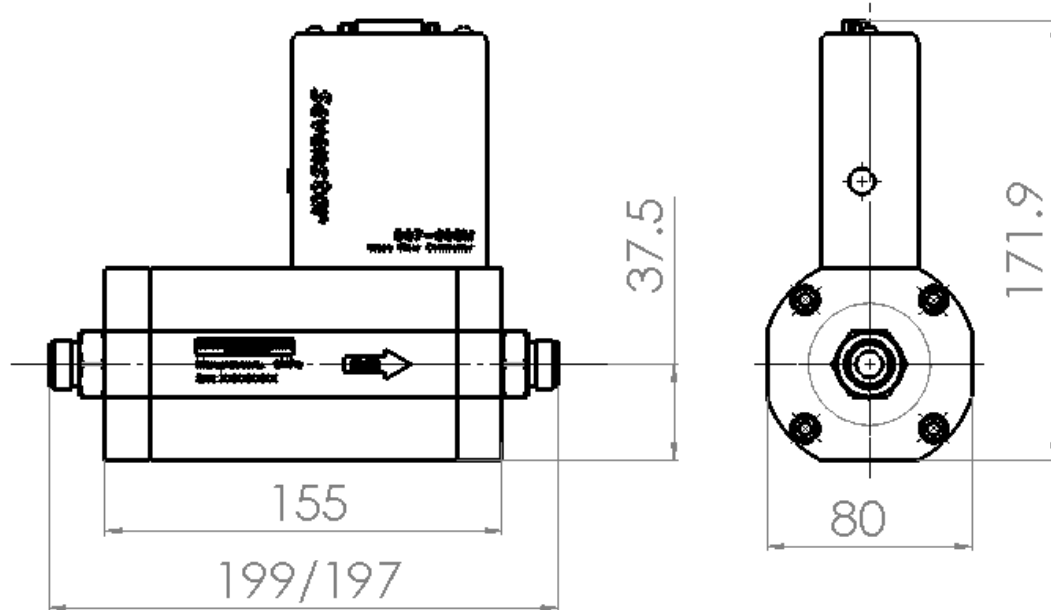
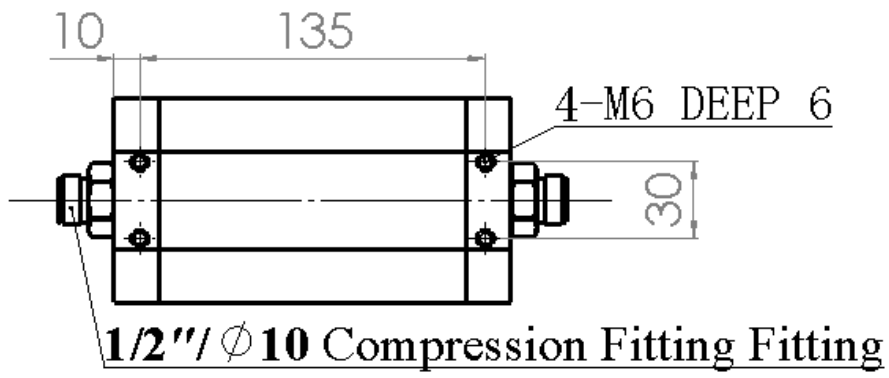

Figure 3c. Dimension of D07-60GM MFM With 1/2" / ϕ 10 Compression Fitting Fitting

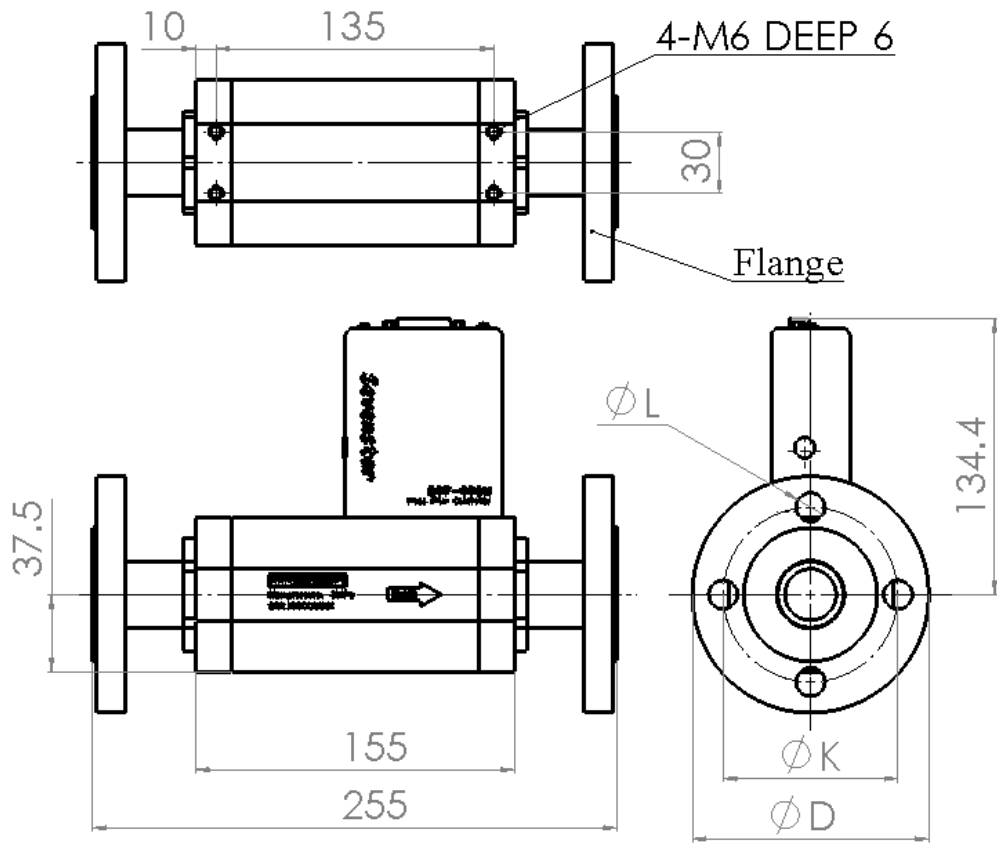

Figure 3d. Dimension of D07-60GM MFC With Flange

Attention:

The height of figure 3a, 3b, 3c, 3d are height without electric connectors of cable. It should be added around 50mm more after adding the electric connector.

4.2 Fittings

Four models of external diameters connectors could be provided:

Table2. Connectors & Dimensions of D07-60G、D07-60GM

No	MFC/MFM Model	Compression Fitting		Note
		Φ10 (300SLM)	1/2" (≤1000SLM)	
1	D07—60G	○	○	Mark"○" means could be selected, but each model only could be selected one connector type at a time.
2	D07—60GM	○	○	

Using standard Compression Fitting connectors, general speaking, stainless steel tube was used to connect MFC and Gas System, matching to the different request, other materials also could be used as nylon tube or hard flexible plastic hose. Figure 4 is an example to showing the fitting structure, please be careful, the flow input & output direction should not be inversed fitted.

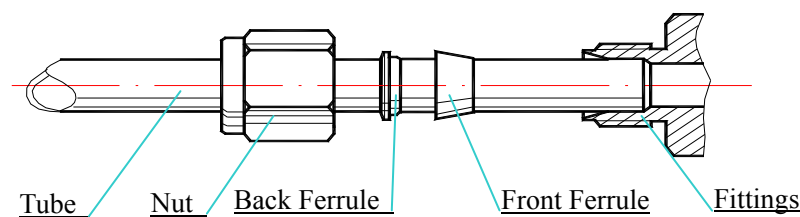

Figure 4. Compression Fitting Connector Installation

Attention:

For installing the fittings, you should manually use spanner to wrench it tighten by 1/2 turn pulling up, (imported Compression Fitting should use spanner to be tighten in 1.25 turns) to prove its not blow-by after your installing the front ferrule, back ferrule and nut. Please note you should use two spanners to operating, one spanner for locking the fitting stable and another one for revolving the nut. Especially when you dismantle the tube, you should operate by the two spanners otherwise fitting will become flexible which will affect its airproof function.

4.3 Electrical Interfacing

MFC could begin operating after it was well connected with professional cable and corresponding Flow Readout Box. The electrical interfacings of each MFC and MFM are showing as following figures (Figure 5 ~ Figure 6).

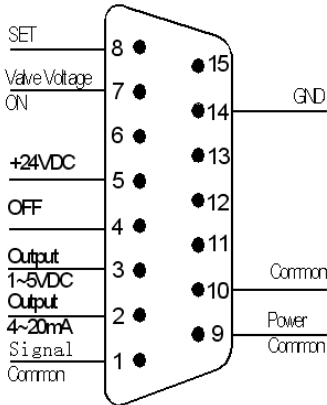

Figure 5. Connection of D07-60G MFC Electrical Interfacing

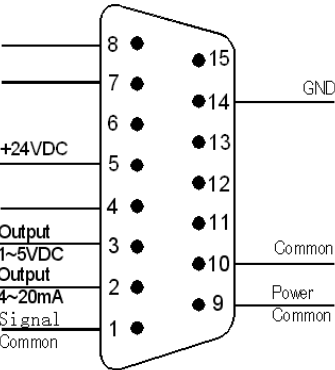

Figure 6. Connection of D07-60GM MFM Electrical Interfacing

4.4 PC Connection

- a. Connection through Flow Readout Box with PC or other external signal. (Figure 7)

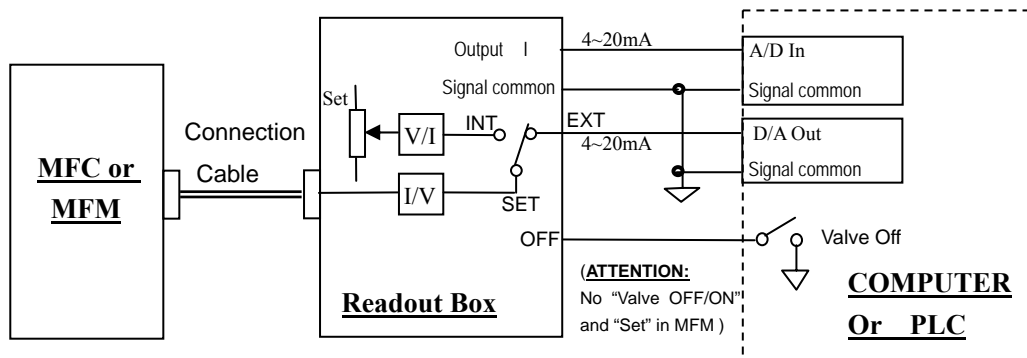

Figure 7. Connection with PC through Readout Box

When need test the output I signal (4~20mA) , users could connect to the “Output I” and the “Signal common” of external control signal socket of Flow Readout Box, also could directly connect with PC modulus (A/D) converter. If flow output signal is voltage signal, +5V output voltage is corresponding as full scale rating flow rate of MFC, +1V output voltage is corresponding as zero scale rating flow. Please be sure the flow testing output electric current will be no more than 3mA.

When the flow is setting by external signals, it should be turned the switch on “EXT”, meanwhile, it should be input 4~20mA external signal from external control socket to the Flow Readout Box. . It also could be directly connecting with modulus (D/A) converter of PC to achieve auto-control.

If PC or PLC need perform the OFF function of valve control, it could be accomplished by use one RELAYS (two sets) transfer contacts, showing in Figure 7.

- b. PC Directly Connections (Figure 8)

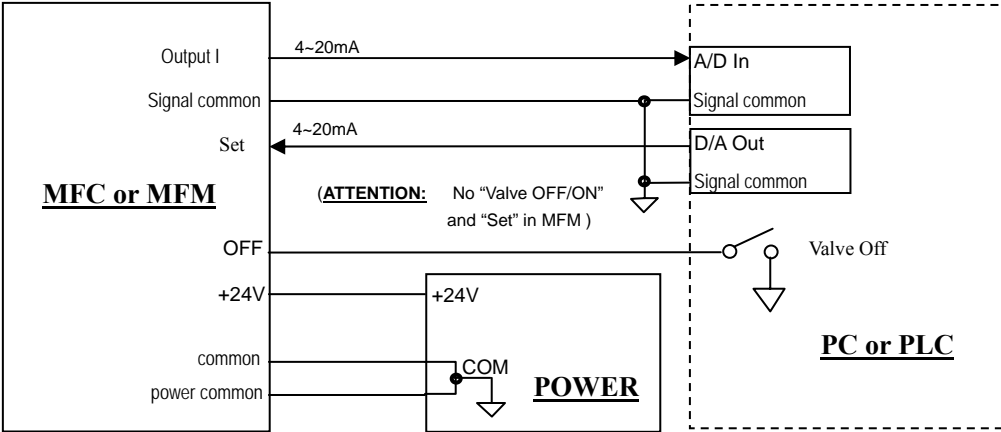

Figure 8. PC Directly Connection

Under the case of MFM/MFC directly connects to PC without Flow Readout Box, 24VDC power supply with good anti-jamming should be provided by user itself; connects SET with PC D/A output; connects "Output I" with PC A/D input; "Signal common" connects signal reference point; low-current "common" and heavy-current "power common" down lead separately, and connects together to the 24VDC power supply common port.

4.5 Zero Adjustment

It could be zero adjusted in case of zero excursions while the first time operates or a long period operating. Users could adjust Zero Potentiometer from side face (showing in figure 9) or adjust it while removed its overall. Please note it should be sure that gas flow tube could not be open while zero adjustment (or shutoff the valves); it should be warming up not less than 15 minutes, adjustment performs after its zero moving to the stable stop. Users should not adjust zero except zero potentiometer, otherwise it will affect device accuracy.

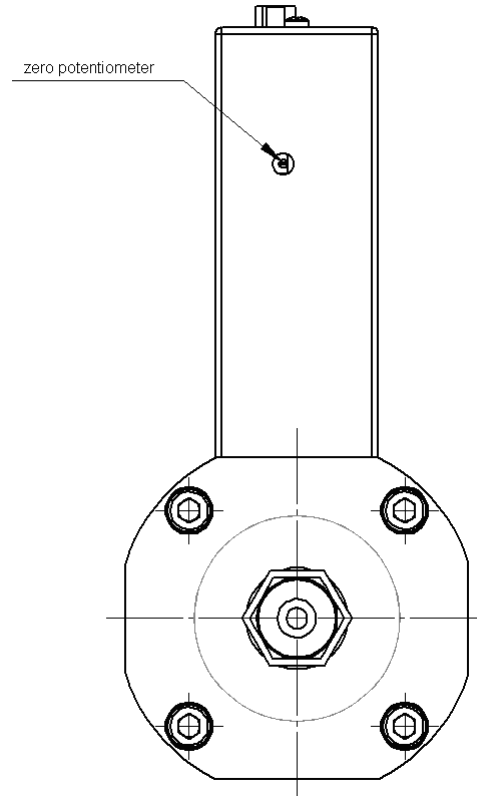

Figure 9. The Position of Potentiometer of D07-60G & D07-60GM

There is another external zero adjustment function, while MFC connected with our new zero adjustment functional D08 Flow Readout Box, it could be achieved by zero potentiometer of display panel. The important is the ranges of external zero adjustment is narrow, when there is big zero excursion happened, it should be better adjust zero from zero potentiometer of MFC.

5. OPERATING INSTRUCTIONS (Together with Flow Readout Box)

5.1 MFC Operation

5.1.1 Start up (Reference to Figure 10)

The main operating should perform in the Flow Readout Box. Valve Control Switches and flow setting potentiometer are in the front of display panel, the flow setting internal or external signal control switches are on the back of panel of Readout Box. When the switch is turned on the "INT" position, the potentiometer will control flow rate; when the switch is turned on "EXT" position, the external signal will control flow rate (Please check out the details in Flow Readout Box Instruction).

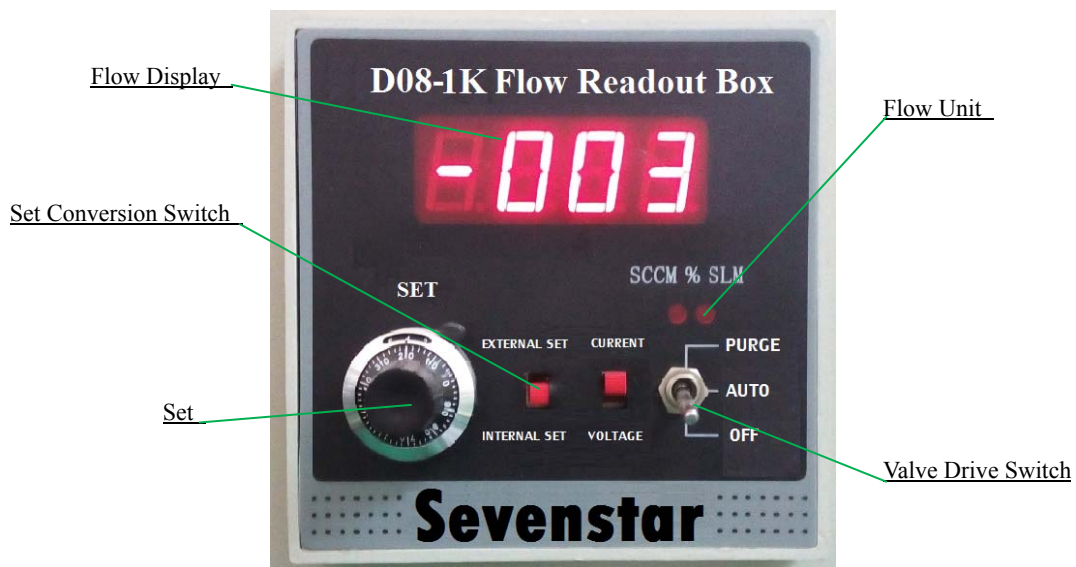

Figure 10. Flow Readout Box Operating Panel

- a. When valve switch is on the position of AUTO, gas supply should be open first and then turn on the power supply, the flow rate will not be beyond 5% of presetting after flow soft-start about 20 seconds. General speaking it should be warming up around 15 minutes in case valves shut off and gas flow cut off, after stable zero movement, normal operation could begin. If there is big zero excursion, please see the reference 4.5, in the case of non-gas flow, it's better adjust zero by zero potentiometer.
- b. If Valve switch is on the position of OFF, after power supplying, gas supplying and warming-up, turn switch to AUTO position, flow rate will reach the presetting 2%(or lower) after a few seconds, which is the suggested operating method.
- c. If Valve switch is on the position of PURGE, the flow rate will reach up to the maximum value after gas and power supplying, which will have the function of air blasting to the gas circuit.
- d. If Valve switch is on the position of AUTO and presetting is not zero, open the gas after power supply, the flow rate will have a big overshoot and then rapidly reach to the stable presetting value, this kind of operation should better be avoided.
- e. The best operating sequence should be:
 1. Open the power supply;
 2. Turn the Valve switch on OFF position;
 3. Open the gas supply;
 4. Warm up for minutes to have stable zero point movement;
 5. Turn the switch on AUTO position;
 6. Set flow rate under request.This is the best way to operate without an overshooting.

5.1.2 PURGE

When need air blasting and cleaning bypass and tube, users could turn the switch on PURGE position, during the purging, flow rate value should reach up to times or even several decuples of the full scale flow value. If shutoff gas supplying, it could be vacuum pumping to get rid of MFC internal or upper reaches remained gas matching request. And then shut off valves, open gas supply again and turn it to AUTO position.

5.1.3 Readout Box & PC Connections

Please find the reference in Figure 5 and Figure 10, it should set the switch of Readout Box to the "External" and turn the switch to the position of "CONTROL", and then startup PC.

5.1.4 PC Connections

Please have the reference in Figure 7 and Figure 8, after MFC warming up, it could have PC startup.

5.1.5 Valve Control

When "OFF" wire connected to "0V", the valve will be shutoff, please find the reference in Figure 2 and Figure 5. When "ON" wire connected to "+24VDC", the valve will be turned to the top of maximum to purge position; when "OFF" wire and "ON" wire both unconnected, valve will be turned to valve control position; Please don't connect "ON" and "OFF" at the same time. when "ON" wire and "OFF" wire work at the same time, the valve will be turn to purge position.

5.1.6 Shut Off Operation

After shutoff power supply, flow will be cut off automatically. It should be better shut off gas supply (Turn valve switch to OFF position and close the cut-off valve of gas circuit) before power supply.

5.2 MFM Operation

5.2.1 Start Up

Please warm up for 15 minutes by power supply before MFM operating.

5.2.2 Zero Testing and Adjustment

Please check up zero point of MFM after its warming up (especially for the first time operating), it could have reference in 4.5, without gas supplying, which could adjust zero by zero potentiometer.

5.2.3 Gas Supply

After zero movement reaches stable, MFM Could have gas supply. Please pay attention to the flow rate, it should be better operate not beyond full scale range.

5.2.4 Shut Off

Turn off the power supply, which means MFM operating will be terminated, it could not affect the flow rate of bypass.

6. CAUTION

6.1 Medium Forbidden

The gas of using should be purified without dust, liquid and oil stain. When necessary, it should be added filter to gas circuit to make sure gas purified. If the outlet of MFC connects with liquid sources, which should be added simple directional valve of MFC outlet to avoid the liquid is reflux to the tube to destroy MFC.

6.2 Corrosive Gas

The materials of bypass are anti-caustic materials like 00Cr17Ni14Mo2(same as 316Lstainless steel), Teflon, and Viton. When users operate in condition of without vapor, low leakage, regular cleaning and proper operating, MFC could possible control the normal corrosive gas. Using ammonia, organic solvent gas such as acetone or other strong caustic gas (like BC13 and BBr3), please informed in your order statements. Valves Dynamic sealing materials usually are Viton. There maybe leakage happened of valve port, valve sealing leakage rate will lower than 2% of full scale flow rate; when use the special caustic gas, all sealing materials should be changed relatively.

For the cases that the MFC/MFM used with toxic, pyrophoric, flammable or corrosive gas, you should ensure that the fixing and fitting are airtight. It becomes necessary to remove the controller from the system, purge the controller thoroughly with a dry inert gas such as nitrogen, before disconnecting the gas connections. Failure to purge the controller could cause a fire or explosion resulting in death.

6.3 Valves Dynamic Sealing

The Valve of MFC is an electric-magnetic valve for adjustment, which is not a solenoid plug valve so that could not perform that kind of function. Users should better have that plug valve by themselves. Especially when users operate with caustic gas, general speaking, it should separately add one cut-off valve of MFC inlet and outlet to protect operating security. After a long period operating, if the leakage rate of MFC valve outlet is not beyond 2% F.S, it is the standard situation. Otherwise, it should be under maintaining.

6.4 Valves operating

When valve is operating PURGE, which should not be directly turned to AUTO, operation should be turned the switch to OFF position and then turn it into AUTO to operating.

6.5 Installation Position

Keeping installation surface horizontal while installation. Please provide the installation position when ordering the MFC. We will calibrate products according to the requirement of customers. The MFC might show the zero drift if it is not installed as the same position of calibration. Customer can adjust zero to fix it.

6.6 Operation Pressure Resistance

Please be caution for the medium operating pressure of MFC, it should not be beyond the rage of specification of inlet and outlet. Especially while operating under the high-pressure situation, the big differential pressure will affect flow fail to shut off or lower adjustment. In case of using heavy flow rate of MFC, please be sure appropriately widen tube and reduce gas internal resistance, if operating differential pressure is lower than the value of request, it might could not be reach to the full scale flow rate value.

6.7 Calibration and Conversion

D07 series is calibrated by nitrogen. Other gas calibrations please inform in your order statements. When the nitrogen calibration users use other gas operating, it could convert and calculate used gas flow rate by conversion factors of appendix 8.1. Which means users could multiply the readout flow rate from MFC Readout Box with the used gas corresponding conversion factors, the result will be the used gas corresponding mass flow rate of standard situation.

For example, there is 1000 SLM (N₂) calibrated MFC, the flow rate is displayed 860 SLM while firedamp flowing, the conversion factors of firedamp is 0.719 from reference of appendix 9.1, the real firedamp flow rate is $860 * 0.719 = 618$ SLM.

If users use the mixture gas, it could be calculated the conversion factors by the method which introducing in appendix 9.2.

6.8 D07-60G,60GM Ordering Code

D07-[t] [g,g,g] [r,r,r,r] [f,f] [s] [m] [d]

[t] -Type Number

- [60G] MFC
- [60GM]MFM

[g,g,g] -Gas

Please consult SEMI52-0302

For Example:

- [013] N₂
- [007] H₂
- [000] Mixture gases (please consult [d] for detail)

[r,r,r,r] -Flow Range Full Scale

- [300L] 300SLM
- [500L] 500SLM
- [750L] 750SLM
- [1K0L] 1000SLM
- [1K5L] 1500SLM
- [2K0L] 2000SLM
- [000C] Customer Special Request (please consult [d] for detail)

[f,f] -Inlet and Outlet Fittings

- [JJ] Compression Fitting ϕ 10mm (F.S.=300SLM)
- [PP] Compression Fitting 1/2"(F.S. \leq 1000SLM)
- [XX] Customer Special fittings (please consult [d] for detail)

D07-[t] [g,g,g] [r,r,r,r] [f,f] [s] [m] [d]

[s] -Seal Materials ←

- [V] Viton
- [N] Neoprene

[m] -Mounting Position ←

- [H] Horizontal
- [E] HESD(Horizontal Edge Side Down)
- [U] Vertical Inlet Up
- [D] Vertical Inlet Down

[d] -Description ←

-[] Default Value:

The letters on cover and tag: in Chinese

Differential Pressure: D07-60G: 300~1000SLM: (0.25~0.50) MPa

1500,2000SLM: (0.40~0.60) MPa

D07-60GM: 300~2000SLM: <0. 2MPa

Max Operating Pressure: 3 MPa

Calibration Temperature: (22±2)°C

-[S] Customer Special Requirements:

For Example: The letters on cover and tag: in English; Customer Special Full Scale:29SLM; The proportion of Mixture gases should be indicated: N₂ (60%) + CO₂(40%); Customer Differential Pressure: (0.08 ~ 0.13) MPa; Customer Calibration Temperature: 40°C; D07-60G Setpoint Signal: Voltage 0~5VDC and other customer special requirements.

For Example: **D07-60G0131K0LPPVHS**

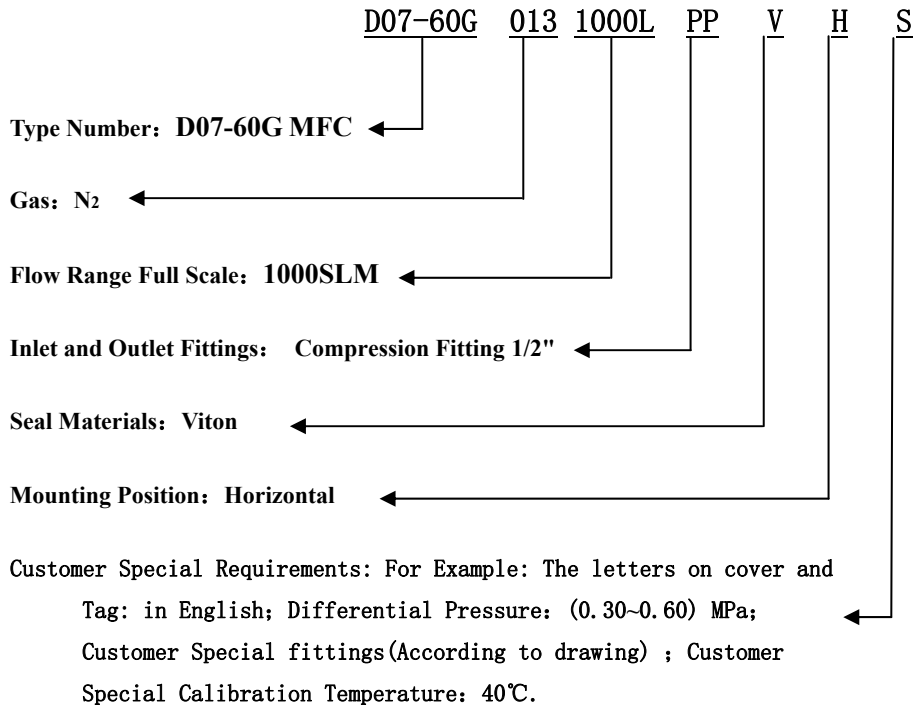

7. TROUBLESHOOTING

Table 3. Failure Handling

NO.	FAILURE	CAUSE	TREATMENT
1	There is no gas flow after turn on.	1.1 Gas flow is shutting off, no gas inputting	Check the gas sourcing and make it open
		1.2 Valve control switch is shutoff	Turn the switch to CONTROL or PURGE
		1.3 No setting signal	Check potentiometer or “In/Out” switch setting position
		1.4 Filter is blocked	* Change a new filter
		1.5 Valve failure	Test or *clean valve
		1.6 Circuit failure	*Repair the electric circuit
2	In case of turning on but without gas flow, the flow rate testing is error.	2.1 Zero excursion	Adjust the zeroing potentiometer
		2.2 Power supply failure	*Check Power supply voltages (24VDC)
		2.3 Sensor failure	*Replace the new sensor
		2.4 Amplifier or other circuits failure	*Replace amplifier or repair circuit
3	In case of valve shutting off, there is still heavy flow rate passing.	3.1 Over- load pressure of input outlet, the differential pressure between inlet and outlet is beyond rating.	Reduce the inlet operating pressure to decrease differential pressure.
		3.2 Pollution of valve	*Clean valve and replace seal ring
		3.3 Valve failure	*Re-adjust solenoid control valve
4	The flow rate display could not reach to full scale flow rate value.	4.1 Pressure is lower than the rating	Heighten the inlet pressure
		4.2 Block of bypass	*Clean bypass
		4.3 Setting voltage is less than 5.00V	*Check the setting Voltage
		4.4 Others trouble	*Repair circuit etc.

Continue To Table 3. Failure Handling

NO.	FAILURE	CAUSE	TREATMENT
5	Fluctuant flow rate	5.1 Inlet pressure is too low or instable	Heighten inlet pressure
		5.2. High internal gas resistance	Lessen internal resistance (The heavy gas flow should have big valve open, widen tube to parallel connecting gas bottles to improve gas supply capacity.)
		5.3 Circuit or valve failure	*Repair and adjust
6	Disturbed by high frequency power sourcing	6.1 Earth wire and zero wire connecting of power supply is error	Check the earth wire connection, should be one port connection.
		6.2 Signal reference port connecting problem	Check signal connecting wire.
		6.3 Inter space disturbing	
7	Flow display is inaccurate	7.1 The range or unit of Display is not matching to controller.	*Re-adjust Display
		7.2 Bypass is polluted to cause the flow rate excursion.	*Clean MFC and re-calibrate it
		7.3 Zero excursion happened to be instable.	* Change sensor and repair circuit
8	There is still flow passing while zero setting.	8.1 Valves leakage	*Repair solenoid control valve
		8.2 Zero point is moving less than 0	Adjust zero
9	The heavy flow is passing but no outputting display	9.1 Block of sensor	*Repair and replace the new sensor Should add filter to block gas dust. Using special gas should be sure of good tube sealing and gas dryness.
		9.2 Circuit failure	*Repair circuit
10	Without gas flow, Zero is fluctuate or excursion happened.	10.1 Sensor failure	*Replace a new sensor

Attention:

* Mark indicates that reparation and adjustment must be dealt under specialist advices.

8. WARRANTY & SERVICE

8.1 Product Warranty

- a. Our products are guaranteed within 1 years warranty against defects in materials and workmanship if used in accordance with specifications and not subject to physical damage, contamination, alteration or retrofit.
- b. Buyers undertake to check and inspect the goods and to notify SevenStar of shipment incidents by fax, phone or e-mail as soon as possible after receipting the goods.
- c. During the warranty period, products must only be repaired by Sevenstar or authorized SevenStar service centers; otherwise, the SevenStar product warranty will be invalidated.
- d. Repairs will be performed free of charge during the one-year warranty period. If MFCs/MFMs are out of warranty, SevenStar will notify the owner of replacement or repair costs before proceeding. Factory service and repairs are guaranteed 90 days. The warranty excludes consumable materials and wear parts (in teflon, viton, etc.).
- e. No MFC/MFM used with dangerous gas will be accepted for repair or warranty without a decontamination and purge certificate.

8.2 Specific warranty requirements are as follows :

- a. Gas must be clean and particle-free, which means a filter(<30μ) must be fitted in the gas line upstream of the MFC/MFM.
- b. Gas must comply with the pressure specifications, and never exceed the rated value.
- c. Process gas should be in line with the seal materials chosen in the order, especially in case of corrosive gas. We shall not be responsible for any damage caused by changing process gas or choosing the wrong seal materials in order.
- d. Electrical connection requirements are as follows: The system must be wired carefully: non-observance of the pin out may irreversibly damage the electronic board inside the products. If user self scheme power supply of MFCs, a stable and anti-jamming power supply is required, with ripple below 5mV.
- e. Gas connections: the fittings must be handled carefully. We guarantee that all fittings have been individually inspected and are scratch-free.
- f. The MFC/MFM must not be dismantled: the MFC/MFM warranty will be invalidated if the seal between the MFC/MFM block and cover is torn.

8.3 Service

Our product engineer will help you with issues related to operation, calibration, installation, process specification, gas convention, etc. And we also provide you with technology support& maintenances, and products operation training.

Please visit www.mfcsevenstar.cn for relevant information and the locations of our service centers.

9. APPENDIX

9.1 Mass Flow Conversion Factors

Table 4. Conversion Factors

GAS	GAS CODE (SEMIE52-0302)	HEAT (Cal/g °C)	ρ (g/l 0°C)	Factors
Air	008	0.2400	1.2930	1.006
Ar	004	0.1250	1.7837	1.415
AsH ₃	035	0.1168	3.4780	0.673
BBr ₃	079	0.0647	11.1800	0.378
BCl ₃	070	0.1217	5.2270	0.430
BF ₃	048	0.1779	3.0250	0.508
B ₂ H ₆	058	0.5020	1.2350	0.441
CCl ₄	101	0.1297	6.8600	0.307
CF ₄	063	0.1659	3.9636	0.420
CH ₄	028	0.5318	0.7150	0.719
C ₂ H ₂	042	0.4049	1.1620	0.581
C ₂ H ₄	038	0.3658	1.2510	0.598
C ₂ H ₆	054	0.4241	1.3420	0.481
C ₃ H ₄	068	0.3633	1.7870	0.421
C ₃ H ₆	069	0.3659	1.8770	0.398
C ₃ H ₈	089	0.3990	1.9670	0.348
C ₄ H ₆	093	0.3515	2.4130	0.322
C ₄ H ₈	104	0.3723	2.5030	0.294
C ₄ H ₁₀	111	0.4130	2.5930	0.255
C ₅ H ₁₂	240	0.3916	3.2190	0.217
CH ₃ OH	176	0.3277	1.4300	0.584
C ₂ H ₆ O	136	0.3398	2.0550	0.392
C ₂ H ₃ Cl ₃	112	0.1654	5.9500	0.278
CO	009	0.2488	1.2500	1.000
CO ₂	025	0.2017	1.9640	0.737
C ₂ N ₂	059	0.2608	2.3220	0.452
Cl ₂	019	0.1145	3.1630	0.858
D ₂	014	1.7325	0.1798	0.998
F ₂	018	0.1970	1.6950	0.931
GeCl ₄	113	0.1072	9.5650	0.267

Continue To Table 4. Conversion Factors

GAS	GAS CODE (SEMIE52-0302)	HEAT (Cal/g °C)	ρ (g/l 0°C)	Factors
GeH ₄	043	0.1405	3.4180	0.569
H ₂	007	3.4224	0.0899	1.010
HBr	010	0.0861	3.6100	1.000
HCl	011	0.1911	1.6270	1.000
HF	012	0.3482	0.8930	1.000
HI	017	0.0545	5.707	0.999
H ₂ S	022	0.2278	1.5200	0.844
He	001	1.2418	0.1786	1.415
Kr	005	0.0593	3.7390	1.415
N ₂	013	0.2486	1.2500	1.000
Ne	002	0.2464	0.9000	1.415
NH ₃	029	0.5005	0.7600	0.719
NO	016	0.2378	1.3390	0.976
NO ₂	026	0.1923	2.0520	0.741
N ₂ O	027	0.2098	1.9640	0.709
O ₂	015	0.2196	1.4270	0.992
PCl ₃	193	0.1247	6.1270	0.358
PH ₃	031	0.2610	1.5170	0.691
PF ₅	143	0.1611	5.6200	0.302
POCl ₃	102	0.1324	6.8450	0.302
SiCl ₄	108	0.1270	7.5847	0.284
SiF ₄	088	0.1692	4.6430	0.348
SiH ₄	039	0.3189	1.4330	0.599
SiH ₂ Cl ₂	067	0.1472	4.5060	0.412
SiHCl ₃	147	0.1332	6.0430	0.340
SF ₆	110	0.1588	6.5160	0.264
SO ₂	032	0.14890	2.8580	0.687
TiCl ₄	114	0.1572	8.4650	0.206
WF ₆	121	0.0956	13.2900	0.215
Xe	006	0.0379	5.8580	1.415

9.2 Conversion Factors Instruction

MFC and MFM are standard calibrated by N₂ while it's out of factory. Other gas calibrations can be approximated by converting of conversion factors of our instruction. While using other gas operating:

One single gas: The conversion factors could find out in the users specification instruction.

A mixture of two or more gases: Assume there is “n” sorts of gases, could calculate the conversion factors C by the following formula:

Basic Formula: $C=0.3106 N / \rho (Cp)$

ρ — Density of the gas

Cp — Specific heat of the gas

N — Structure factors of gas-molecule (See Table 6.)

Table 6. Gas-Molecule Composing factors

COMPOSITION	EXAMPLE		N VALUE
Single atom numerator	Ar	He	1.01
Double atom numerator	CO	N ₂	1.00
Tree atom numerator	CO ₂	NO ₂	0.94
Multi-atom numerator	NH ₃	C ₄ H ₈	0.88

For mixture gases: $N = N_1 (\omega_1/\omega_T) + N_2 (\omega_2/\omega_T) + \dots + N_n (\omega_n/\omega_T)$

Then:

$$C = \frac{0.3106 [N_1 (\omega_1/\omega_T) + N_2 (\omega_2/\omega_T) + \dots + N_n (\omega_n/\omega_T)]}{\rho_1 Cp_1 (\omega_1/\omega_T) + \rho_2 Cp_2 (\omega_2/\omega_T) + \dots + \rho_n Cp_n (\omega_n/\omega_T)}$$

$\omega_1 \dots \omega_n$ — The flow of single gas

ω_T — The flow of mixture gas

$\rho_1 \dots \rho_n$ — The density of single gas

$CP_1 \dots CP_n$ — Specific heat of the single gas

$N_1 \dots N_n$ — Structure factors of gas-molecule (See Table 6.)

Attention

- 1) **Standard: Temperature 273.15K (0 °C); Air Pressure— 101325 Pa (760mm Hg)**
- 2) **Please feel free to contact us if the request gas conversion factors could not be found in our appendix.**

D07 Series

Mass Flow Controller

Beijing Sevenstar Electronics Co., Ltd.

Mass Flow Meter Subsidiary Co., Ltd.

Address: No.1 Jiuxianqiao East Rd., Chaoyang District, Beijing, China
P.O.BOX 3#741, Beijing, China
Post code: 100015
Tel: (+86)-10-64361831 ext. 8527
Fax: (+86)-10-64362923
Homepage: www.mfcsevenstar.cn
E-Mail: mfcsales@sevenstar.com.cn

Shanghai Office: Rm.722 Bldg.29, No.368, Zhangjiang Rd, Pudong New Area,
Shanghai, China

Tel: (+86)-21-63532370
Fax: (+86)-21-63533265

Shenzhen Office: Room 712, Section B, Qiche Tower, No.45 Zhenhua Road,
Futian District, Shenzhen, China

Zip code: 518031
Tel: (+86)-755-88290258
Fax: (+86)-755-88294770

*Description may be changed following improvements to product. The information contained in this document is subject to change without notice

*If there is any mistake in this uses manual, please feel free to contact us.

*©2010 Beijing Sevenstar Electronics Co.,Ltd.

All rights reserved.