

LQ-2190 安裝說明

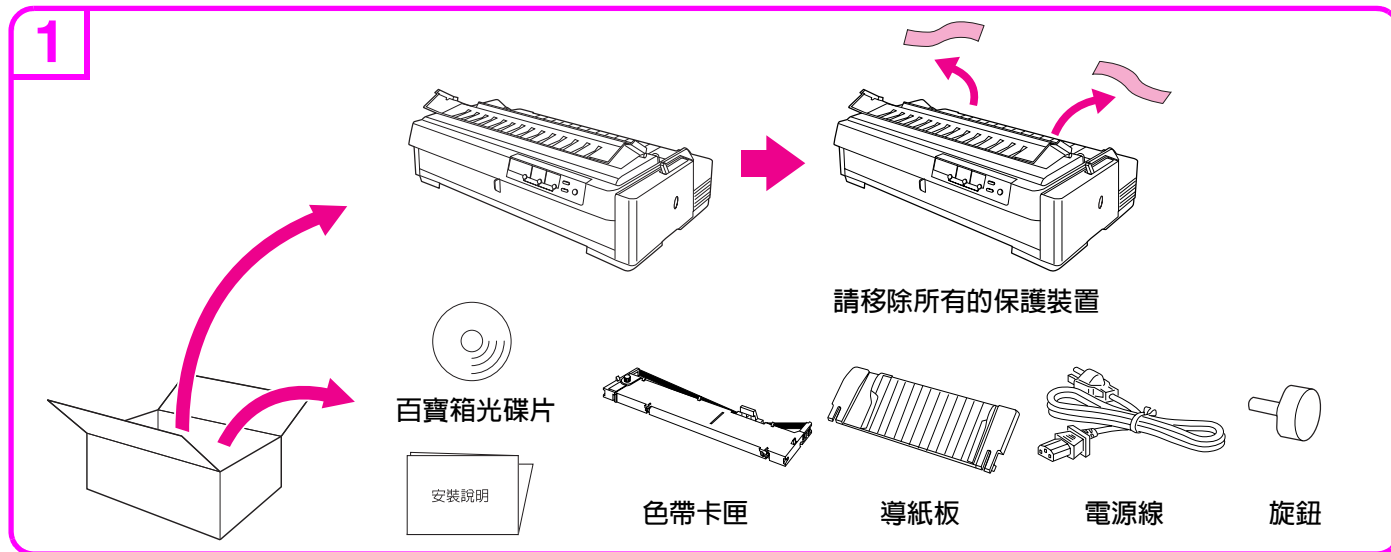

清點配件



安裝色帶卡匣

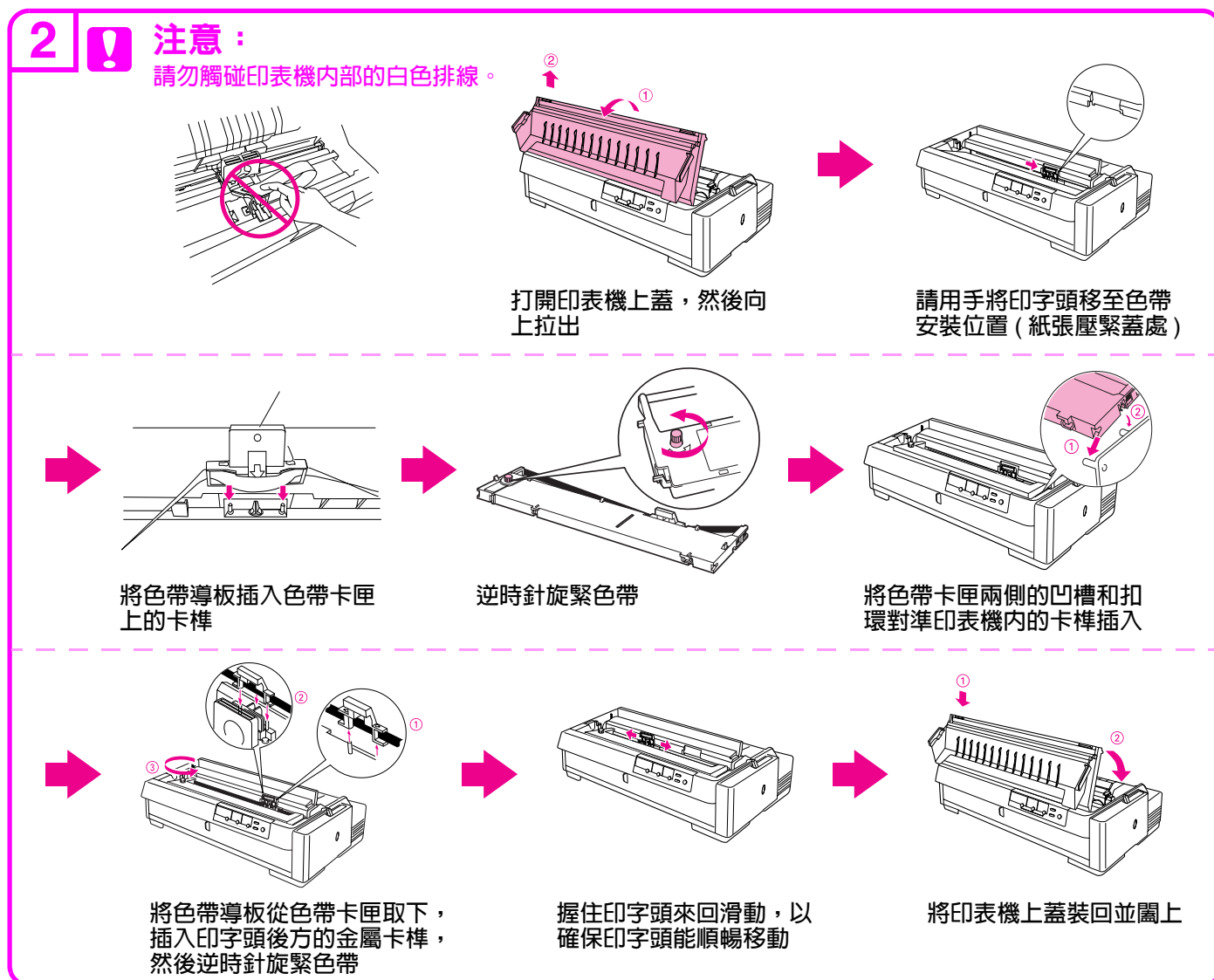

組裝印表機

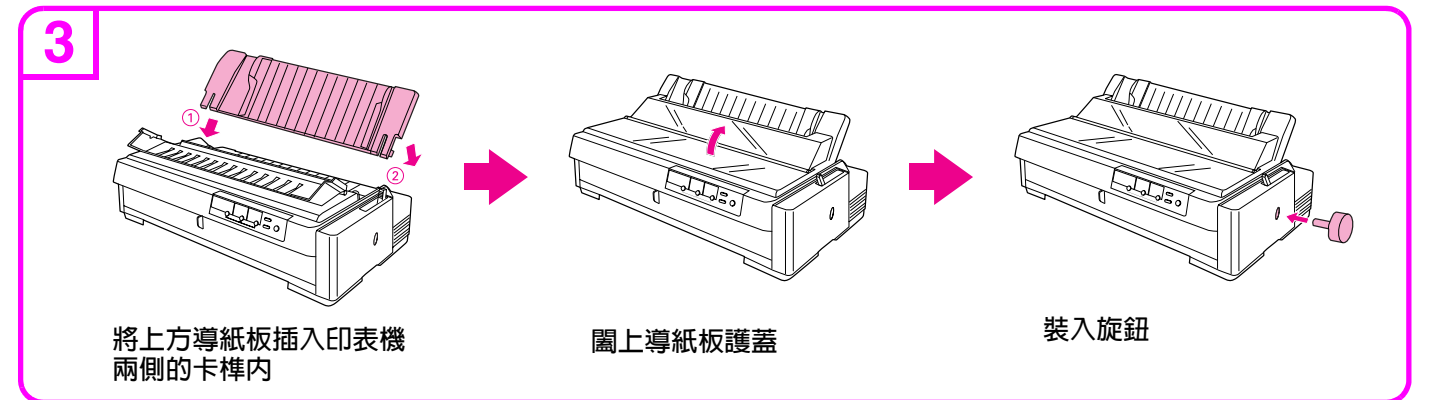

將印表機連接至電腦

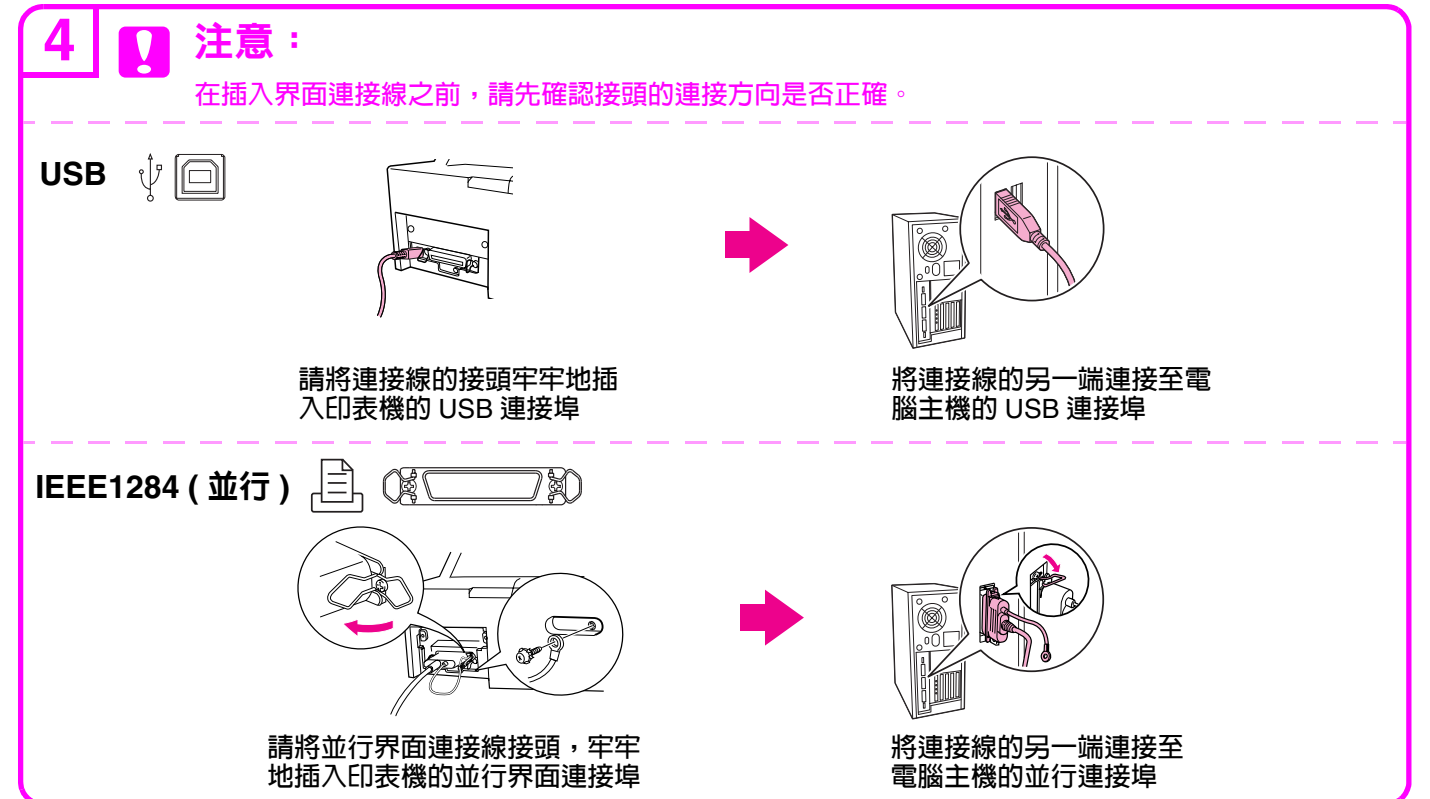

連接電源線

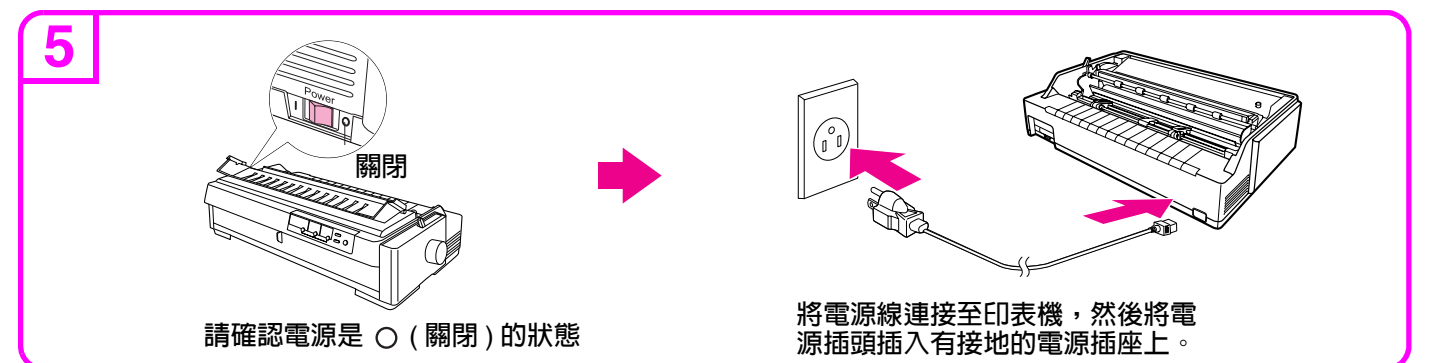

接續 ➡

接續背面 ➡

安裝印表機軟體

6 Windows®

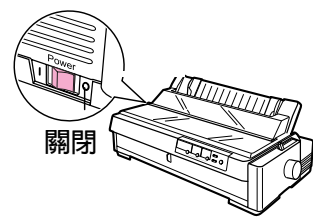

關閉
請確認電源是 ○ (關閉) 的狀態

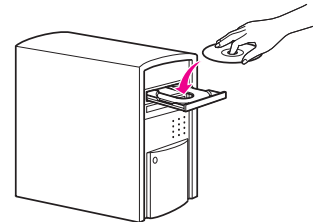

將百寶箱光碟片放入光碟機中

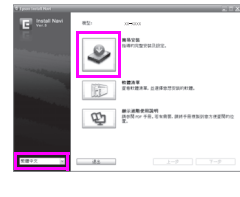

按下『簡易安裝』鍵



Windows Vista® 和 7 使用者請按下『繼續』鍵

請依照螢幕上的指示操作



開啓
開啓印表機的電源

附註：
安裝印表機軟體時，可能必須具有管理員權限。如果您有任何問題，請洽詢管理員。

放置紙張

7 使用後方推送式牽引器列印連續報表紙

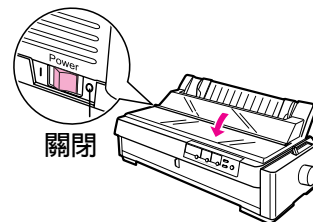

關閉
請關閉印表機電源，然後打開導紙板護蓋

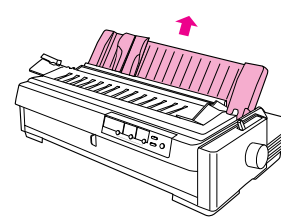

移除上方導紙板

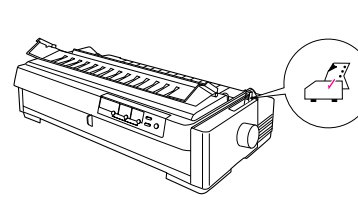

將紙張選擇桿移至後方推送式進紙位置

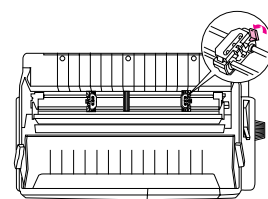

將兩邊固定桿前推以鬆開送紙輪

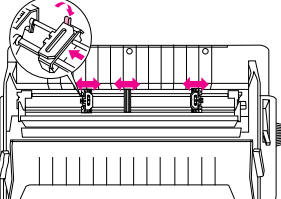

將左邊的送紙輪固定在刻度 0 的位置，然後依紙張寬度調整右送紙輪 (暫不固定)，並將中間的支撐器移至兩個送紙輪的中間

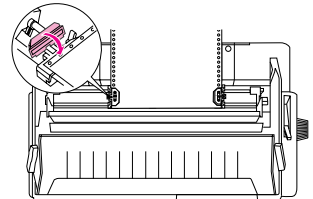

打開送紙輪上的活蓋，將報表紙頂端前 4 孔置入送紙輪上的孔針 (列印面朝下)，然後關上活蓋

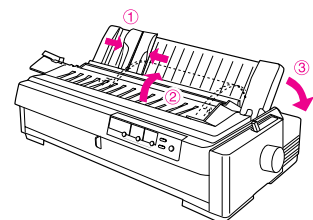

將上方導紙板裝回，並將上方導紙板左、右兩邊的紙張邊緣定位器移到中間，然後關上導紙板護蓋

附註：
您不僅可以使用後方推送式牽引器列印連續報表紙，還能使用前方推送式牽引器以及拖曳式牽引器列印連續報表紙。

列印單張紙

使用上方進紙槽

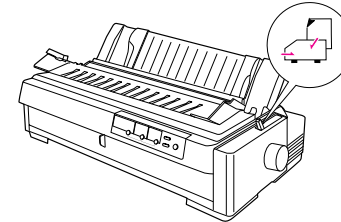

將紙張選擇桿移至單張紙進紙的位置

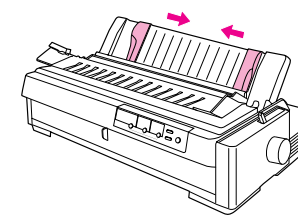

調整左邊的紙張邊緣定位器，使其對準導紙板上的箭頭，再依紙張大小調整右邊的紙張邊緣定位器

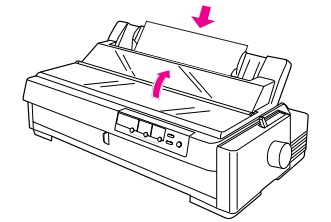

關上導紙板護蓋，然後放入紙張

使用前方進紙槽

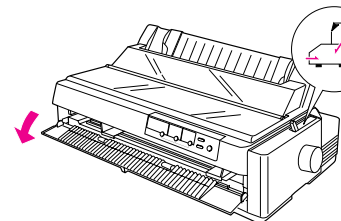

將紙張選擇桿調至單張紙的位置，打開前方導紙板

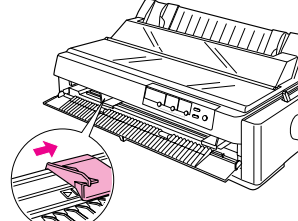

調整左邊的紙張邊緣定位器，使其對準導紙板上的箭頭，再依紙張大小調整右邊的紙張邊緣定位器

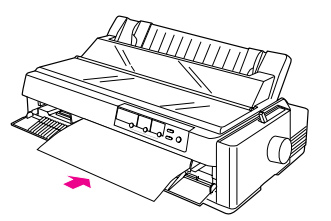

平行裝入紙張直到紙張碰到底部 (列印面朝下)，幾秒之後印表機會自動饋入紙張

8 印表機安裝完成，並準備就緒

關於印表機和故障排除的詳細資訊，請查看“進階使用說明”



使用滑鼠拖放功能複製或雙擊滑鼠左鍵開啓

其他資訊

電力規格

- 額定電壓：110V ± 10%
- 額定電壓：50 - 60 Hz
- 額定電流：1.0A
- 耗電量：46 W (ISO/IEC 10561 letter pattern)

警語

檢修本產品之前，請先拔掉本產品的電源線。

功能規格

- 列印方式：撞擊式點矩陣
- 適用系統：Microsoft Windows 7、Vista、Windows XP、2000

緊急處理方法

- 發生下列狀況時，請先拔下印表機的電源線並洽詢 Epson 授權服務中心：
- 電源線或插頭損壞
- 有液體噴灑到印表機
- 印表機摔落或鐵架損壞
- 印表機無法正常操作或是列印品質與原來有明顯落差

注意事項

- 只能使用印表機標籤上所註明的電源規格。
- 請遵守印表機上所有的警示和說明。

製造年份及製造號碼：見機體標示生產國別：見機體標示

製造廠商：SEIKO EPSON CORPORATION
地址：80 Harashinden, Hirooka, Shiojiri-shi, Nagano-Ken, 399-0785, JAPAN
電話：81-263-52-2552

進口商：台灣愛普生科技股份有限公司
地址：台北市信義區松仁路 7 號 14 樓
電話：(02) 8786-6688 (代表號)

No part of this publication may be reproduced, stored in a retrieval system, or transmitted in any form or by any means, electronic, mechanical, photocopying, recording, or otherwise, without the prior written permission of Seiko Epson Corporation. No patent liability is assumed with respect to use of the information contained herein. Neither is any liability assumed for damages resulting from the use of the information contained herein. Neither Seiko Epson Corporation nor its affiliates shall be liable to the purchaser of this product or third parties for damages, losses, costs, or expenses incurred by the purchaser or third parties as a result of: accident, misuse, or abuse of this product or unauthorized modifications, repairs, or alterations to this product, or (excluding the U.S.) failure to strictly comply with Seiko Epson Corporation's operating and maintenance instructions. Seiko Epson Corporation and its affiliates shall not be liable against any damages or problems arising from the use of any options or any consumable products other than those designated as Original Epson Products or Epson Approved Products by Seiko Epson Corporation. EPSON is a registered trademark of Seiko Epson Corporation. Microsoft, Windows, Windows Vista, and Windows 7 are registered trademarks or a trademark of Microsoft Corporation in the United States and/or other countries.

General Notice: Other product names used herein are for identification purposes only and may be trademarks of their respective owners. Epson disclaims any and all rights in those marks.

Copyright © 2010 Seiko Epson Corporation. All rights reserved.
Printed in XXXXXX