

724 5210

ALU-STAR Profile System Accessories

Footplates

Material: steel, galvanized

These footplates can be used to accommodate adjustable footpads or castors and fix them to 50 x 100 or 40 x 80 profiles.

A 2 x M6 mounting kit is needed to mount the footplates to the profiles.

An insert driver is required. See "Tools".

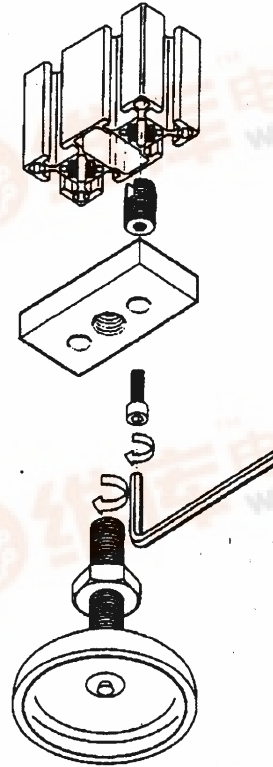

Footplate dimensions			Number of holes
B mm	H mm	Y mm	
50	100	50	2
40	80	40	2

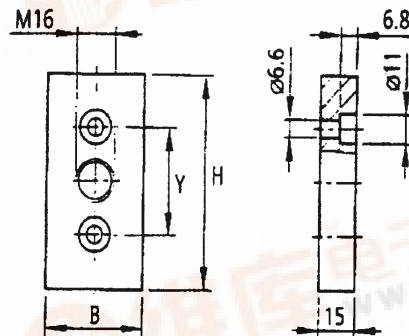

Scope of supply

Footplate mounting kit, 2 x M6

- 2 pcs. thread reducer insert M6
- 2 pcs. hex. socket screw M6x20

Description

- * Footplate 50 x 100
- Footplate 40 x 80
- Footplate mounting kit, 2 x M6

Part number

- 0107-210-32
- 0107-210-29
- 0107-200-09